

Серия KLSS

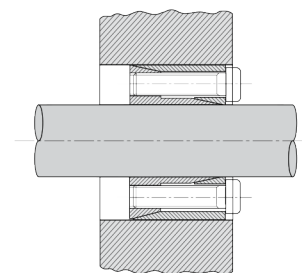
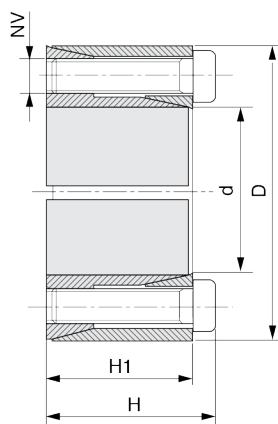

Материал: сталь С 45 Е – UNI EN 10083–1
Размеры перед сборкой

| КОД | Размеры, мм | | | | Затяжка | | | Ослабление | | Характеристики | | Давление на поверхность | |
|---------|-------------|----|------|----------------|---------|---------|-------------------|------------|-------------------|----------------|---------|-------------------------|-------------------------|
| | d | D | H | H ₁ | NV | Tv (Нм) | Количество винтов | NV | Количество винтов | Mt (Нм) | Ta (кН) | Pa (Н/мм ²) | Pm (Н/мм ²) |
| KLSS010 | 10 | 20 | 15,5 | 13 | M2,5x12 | 1,2 | 4 | M2,5x12 | 2 | 19 | 3,8 | 89 | 45 |
| KLSS011 | 11 | 22 | 15,5 | 13 | M2,5x12 | 1,2 | 4 | M2,5x12 | 2 | 21 | 3,8 | 81 | 41 |
| KLSS012 | 12 | 22 | 15,5 | 13 | M2,5x12 | 1,2 | 4 | M2,5x12 | 2 | 23 | 3,8 | 75 | 41 |
| KLSS014 | 14 | 26 | 20 | 17 | M3x16 | 2,1 | 4 | M3x16 | 2 | 39 | 5,5 | 71 | 38 |
| KLSS015 | 15 | 28 | 20 | 17 | M3x16 | 2,1 | 4 | M3x16 | 2 | 42 | 5,5 | 66 | 35 |
| KLSS016 | 16 | 32 | 21 | 17 | M4x16 | 4,9 | 4 | M4x16 | 2 | 77 | 9,6 | 107 | 54 |
| KLSS017 | 17 | 35 | 25 | 21 | M4x20 | 4,9 | 4 | M4x20 | 2 | 82 | 9,6 | 81 | 40 |
| KLSS018 | 18 | 35 | 25 | 21 | M4x20 | 4,9 | 4 | M4x20 | 2 | 87 | 9,6 | 77 | 40 |
| KLSS019 | 19 | 35 | 25 | 21 | M4x20 | 4,9 | 4 | M4x20 | 2 | 91 | 9,6 | 73 | 40 |
| KLSS020 | 20 | 38 | 26 | 21 | M5x20 | 10 | 4 | M5x30 | 2 | 157 | 15,7 | 113 | 60 |
| KLSS022 | 22 | 40 | 26 | 21 | M5x20 | 10 | 4 | M5x20 | 2 | 173 | 15,7 | 103 | 57 |
| KLSS024 | 24 | 47 | 32 | 26 | M6x24 | 17 | 4 | M6x24 | 2 | 268 | 22,3 | 110 | 56 |
| KLSS025 | 25 | 47 | 32 | 26 | M6x24 | 17 | 4 | M6x24 | 2 | 279 | 22,3 | 105 | 56 |
| KLSS028 | 28 | 50 | 32 | 26 | M6x24 | 17 | 6 | M6x24 | 3 | 468 | 33,5 | 141 | 79 |
| KLSS030 | 30 | 55 | 32 | 26 | M6x24 | 17 | 6 | M6x24 | 3 | 502 | 33,5 | 132 | 72 |
| KLSS032 | 32 | 55 | 32 | 26 | M6x24 | 17 | 6 | M6x24 | 3 | 535 | 33,5 | 123 | 72 |
| KLSS035 | 35 | 60 | 37 | 31 | M6x28 | 17 | 8 | M6x28 | 4 | 781 | 44,6 | 125 | 73 |
| KLSS038 | 38 | 65 | 37 | 31 | M6x28 | 17 | 8 | M6x28 | 4 | 848 | 44,6 | 115 | 67 |
| KLSS040 | 40 | 65 | 37 | 31 | M6x28 | 17 | 8 | M6x28 | 4 | 892 | 44,6 | 110 | 67 |
| KLSS042 | 42 | 75 | 44 | 36 | M8x34 | 41 | 6 | M8x34 | 3 | 1272 | 60,6 | 122 | 68 |
| KLSS045 | 45 | 75 | 44 | 36 | M8x34 | 41 | 6 | M8x34 | 3 | 1363 | 60,6 | 113 | 68 |
| KLSS048 | 48 | 80 | 44 | 36 | M8x34 | 41 | 8 | M8x34 | 4 | 1938 | 80,8 | 142 | 85 |
| KLSS050 | 50 | 80 | 44 | 36 | M8x34 | 41 | 8 | M8x34 | 4 | 2019 | 80,8 | 136 | 85 |