

Caliper inspection set

For checking the accuracy of DIN 862 calipers. The set consists of three special steel gauge blocks (30 mm, 41.3 mm and 131.4 mm, ISO 3650 class 1), two steel setting rings ($\varnothing 4$ mm and $\varnothing 25$ mm) and a pair of gloves.



Item No.	Description
----------	-------------

909.347	Caliper inspection set
---------	------------------------

Depth measuring base for calipers

Universal depth measuring base for stable and accurate depth measurements. Suitable for most of the calipers with a depth rod and a measuring range up to 200 mm. For more information please contact our sales department.

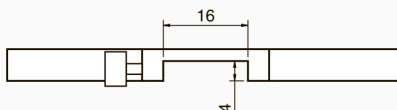
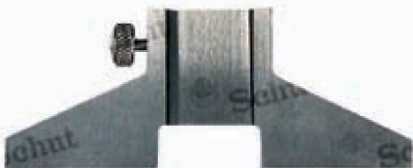

Item No.	Measuring face $l \times w$ /mm
----------	---------------------------------

909.156	75 x 6
---------	--------

Depth measuring bases for calipers

Universal depth measuring bases for stable and accurate depth measurements. Suitable for most of the calipers with a depth rod and a measuring range up to 200 mm. For more information please contact our sales department.



909.386



Item No.	Measuring face $l \times w$ /mm	Height h /mm
----------	---------------------------------	----------------

909.386	80 x 8	20
---------	--------	----

909.387	100 x 8	24
---------	---------	----

