

## Cam & Groove Type Line Drawings

**B**

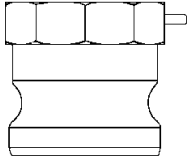

**Type A**

(male adapter x female NPT)

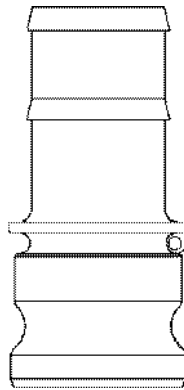

**Type E**

(male adapter x hose shank)

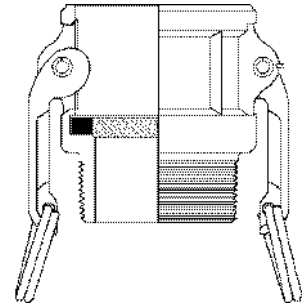

**Type B**

(female adapter x male NPT)

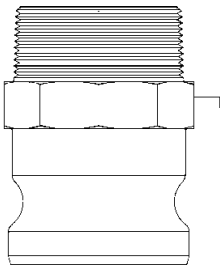

**Type F**

(male adapter x male NPT)

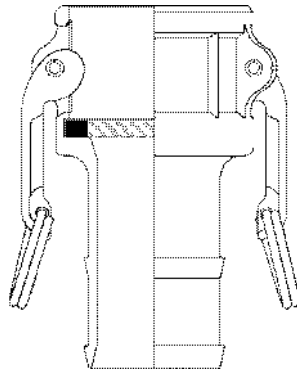

**Type C**

(female coupler x hose shank)

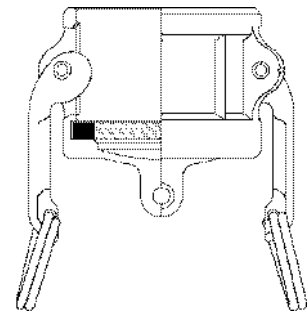

**Type DC\***

(dust cap)

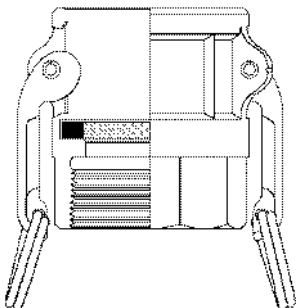

**Type D**

(female coupler x female NPT)

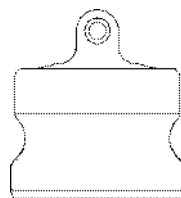

**Type DP\***

(dust plug)

**Note:** Line drawings are representative of the Dixon line of cam and groove.

\* Dust caps and dust plugs are not to be used in pressure applications for safety and environmental reasons.

**WARNING:**  
Under no circumstances should cam and groove couplings be used for compressed air or steam service!

All “Dixon”, “Andrews”, “Boss-Lock” and “EZ Boss-Lock” Cam & Groove couplers and adapters are produced to interchange with all product produced to A-A-59326B.

No standard exists for 1/2”, 5” and 8” fittings, and generally these sizes do not interchange with other manufacturers.

“Andrews” and “Boss-Lock” Cam and Groove Couplings do not interchange in the 8” size. (8” “Andrews” design has 4 cam arms).

DIN Standard Cam & Groove Couplers are produced in accordance with BS EN 14420-7:2004 (formally DIN2828).

Dixon High Pressure couplings will interchange dimensionally with both A-A-59326B and BS EN 14420-7:2004. Couplings for Rubber Hose are available to special order.

Dust Caps and Dust Plugs are **NOT** to be used in pressure applications for safety and environmental reasons.

**Threads:**

Male threads are either BSPT in accordance with BS21/DIN 2999 or NPT in accordance with ANSI/ASME B1.20.1

Female threads are either BSP PL. in accordance with BS2779/DIN ISO 228 or NPT in accordance with ANSI/ASME B1.20.1

PRESSURE RATINGS FOR A-A-59326B COUPLINGS							
SIZE	0.5in DN15	0.75in-2in DN20-DN50	2.5in DN65	3in DN80	4in DN100	5in and 6in DN125-DN150	8in DN200
<b>A-A-59326B BSEN14420</b>	150 psi	250 psi 10 Bar	150 psi 10 Bar	125 psi 10 Bar	100 psi 10 Bar	75 psi	50 psi

Pressure Ratings for Dixon High Pressure Cam & Groove Couplings – 60 Bar all sizes with the exception of 2.5” x 2” Coupler (HPCG65BSPF) which is 100 bar/1450 psi.

Pressure Ratings for Polypropylene Cam & Groove – 100 psi/7 Bar.

Note: All pressure recommendations are based on mating couplings at ambient temperature 21°C (70°F).

**Types:**

**Andrews / Dixon**



**Boss Lock**



**EZ Boss Lock**



## Standard Cam & Groove A-A-59326B

**B**



DIXON CAM & GROOVE TYPE A ADAPTER x NPT THREADS A-A-59326B			
BSP PL. PART NO.	NPT PART NO.	SIZE	MATERIAL
50AALB	50AALN	1/2"	Aluminium
7550AALB	7550AALN	3/4" x 1/2"	Aluminium
75AALB	75AALN	3/4"	Aluminium
100AALB	100AALN	1"	Aluminium
125AALB	125AALN	1 1/4"	Aluminium
150AALB	150AALN	1 1/2"	Aluminium
200AALB	200AALN	2"	Aluminium
250AALB	250AALN	2 1/2"	Aluminium
300AALB	300AALN	3"	Aluminium
400AALB	400AALN	4"	Aluminium
500AALB	500AALN	5"	Aluminium
600AALB	600AALN	6"	Aluminium
800AALB	800AALN	8"	Aluminium
DAL50 AB	DAL50 AN	1/2"	Die Cast Aluminium
DAL7550 AB	DAL7550 AN	3/4" x 1/2"	Die Cast Aluminium
DAL75 AB	DAL75 AN	3/4"	Die Cast Aluminium
DAL100 AB	DAL100 AN	1"	Die Cast Aluminium
DAL125 AB	DAL125 AN	1 1/4"	Die Cast Aluminium
DAL150 AB	DAL150 AN	1 1/2"	Die Cast Aluminium
DAL200 AB	DAL200 AN	2"	Die Cast Aluminium
DAL250 AB	DAL250 AN	2 1/2"	Die Cast Aluminium
DAL300 AB	DAL300 AN	3"	Die Cast Aluminium
DAL400 AB	DAL400 AN	4"	Die Cast Aluminium
50ABRB	50ABRN	1/2"	Brass
7550ABRB	7550ABRN	3/4" x 1/2"	Brass
75ABRB	75ABRN	3/4"	Brass
100ABRB	100ABRN	1"	Brass
125ABRB	125ABRN	1 1/4"	Brass
150ABRB	150ABRN	1 1/2"	Brass
200ABRB	200ABRN	2"	Brass
250ABRB	250ABRN	2 1/2"	Brass
300ABRB	300ABRN	3"	Brass
400ABRB	400ABRN	4"	Brass
500ABRB	500ABRN	5"	Brass
600ABRB	600ABRN	6"	Brass
50ASSB	50ASSN	1/2"	Stainless Steel
7550ASSB	7550ASSN	3/4" x 1/2"	Stainless Steel
75ASSB	75ASSN	3/4"	Stainless Steel
100ASSB	100ASSN	1"	Stainless Steel
125ASSB	125ASSN	1 1/4"	Stainless Steel
150ASSB	150ASSN	1 1/2"	Stainless Steel
200ASSB	200ASSN	2"	Stainless Steel
250ASSB	250ASSN	2 1/2"	Stainless Steel
300ASSB	300ASSN	3"	Stainless Steel
400ASSB	400ASSN	4"	Stainless Steel
500ASSB	500ASSN	5"	Stainless Steel
600ASSB	600ASSN	6"	Stainless Steel
7550APPB	7550APPN	3/4" x 1/2"	Polypropylene
75APPB	75APPN	3/4"	Polypropylene
100APPB	100APPN	1"	Polypropylene
125APPB	125APPN	1 1/2" x 1 1/4"	Polypropylene
150APPB	150APPN	1 1/2"	Polypropylene
200APPB	200APPN	2"	Polypropylene
300APPB	300APPN	3"	Polypropylene
400APPB	400APPN	4"	Polypropylene