

## Universal digital calipers

Large universal digital calipers made of stainless steel for internal and external measurements. In combination with these universal calipers many inserts are available e.g. for measuring thread. See accessories universal digital calipers. By intake with M2.5 thread very many inserts can be used. Please see the dial indicator accessories section for these inserts.

## Universal digital calipers

- Internal measuring range: 24-650 mm.
- External measuring range: 0-570 mm.
- Resolution: 0.01 mm.
- Accuracy:  $\pm 0.02$  or  $\pm 0.03$  mm.
- mm/inch conversion.
- Opto-RS232C data output.
- On/off switch.
- Reset/preset.
- Interchangeable measuring inserts.
- Many extensions and inserts available.
- Protection: IP65.
- Conforms to factory standard.
- Delivery in a case with two inserts, two insert holders and a measuring report.
- Power supply: 1 battery type CR2032.

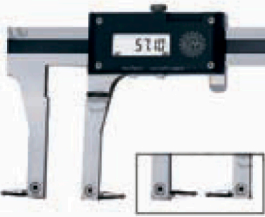

Also models with spring system available.

Item No.	Measuring range/mm		Accuracy mm	Jaw length mm
	internal	external		
839.024 <sup>1</sup>	24-250	0-210	$\pm 0.02$	64
839.025 <sup>2</sup>	42-350	0-270	$\pm 0.03$	103
839.026 <sup>2</sup>	42-450	0-370	$\pm 0.03$	103
839.027 <sup>2</sup>	42-650	0-570	$\pm 0.03$	103

**Options:**  
 495.157 Spare battery  
 781.887 Opto-RS232C cable 9p (2 m)

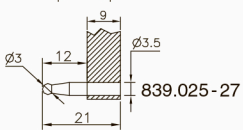
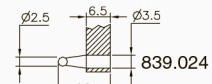

<sup>1</sup> Inserts 837.820 and insert holders standard included.

<sup>2</sup> Inserts 837.821 and insert holders standard included.

## Universal digital calipers with dial indicator

- Internal measuring range: 20-500 mm.
- External measuring range: 0-430 mm.
- Resolution: 0.01 mm.
- Dial indicator: measuring range: 0-5 mm, graduation: 0.01 mm.
- mm/inch conversion.
- Opto-RS232C data output.
- On/off switch.
- Reset/preset.
- Interchangeable measuring inserts.
- Fine adjustment and locking screw.
- Protection: IP65.
- Conforms to factory standard.
- Delivery in a case with a dial indicator, a removable bridge, two inserts  $\phi 3$  mm, two insert holders and a measuring report.
- Power supply: 1 battery type CR2032.

