

Single-row Cylindrical Roller Bearing

d 180~190 mm

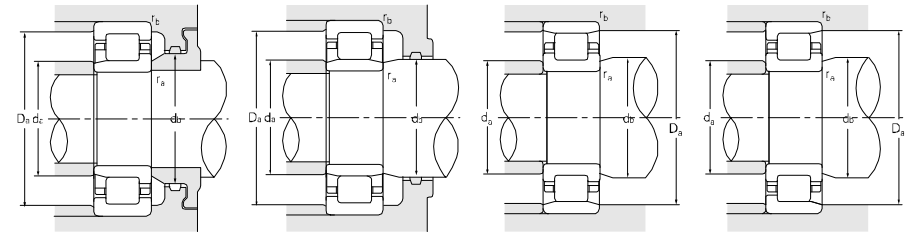
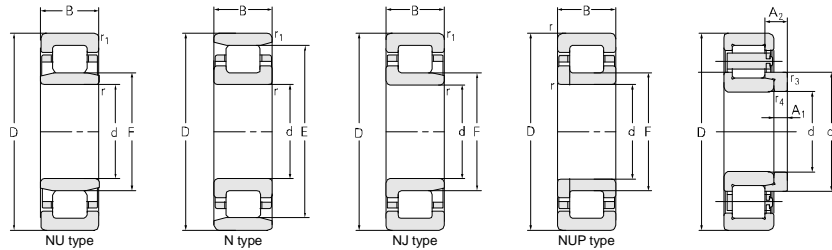

Principal dimensions						Basic load ratings		Limit speed ratings		Designations	
d	D	B	r <sub>1smin</sub>	r <sub>smin</sub>	F	E	C <sub>r</sub>	C <sub>0r</sub>	Grease		Oil
mm						kN		r/min			
180	320	86	4	4	215		1050	1580	1700	2000	NU2236M
	320	86	4	4	215		1100	1580	1700	2000	NU2236EM
	320	86	4	4	215		1050	1580	1700	2000	NJ2236M
	320	86	4	4	215		1100	1580	1700	2000	NJ2236EM
	320	86	4	4	215		1100	1580	1700	2000	NJ2236EQ1
	320	86	4	4	215		1050	1580	1700	2000	NUP2236M
	320	112	4	4	218		1120	1950	1700	2000	NU3236M/C3
	320	112	4	4	218		1120	1950	1700	2000	NU3236M/HC
	380	75	4	4		330	990	1260	1500	1800	N336M
	380	75	4	4	230		990	1260	1500	1800	NU336M
	380	75	4	4	230		990	1260	1500	1800	NJ336M
	380	75	4	4	231		1170	1360	1500	1800	NJ336EM
	380	75	4	4	231		1170	1360	1500	1800	NU336EM
	380	75	4	4	231		1060	1360	1500	1800	NU336EMA
	380	126	4	4	232		1360	1850	1300	1600	NJ2336M
	380	126	4	4	232		1360	1850	1300	1600	NU2336M
190	260	42	2	1.1	208		347	685	2200	2800	NU2938Q1
	260	42	2	2	208		315	610	2200	2800	NJ2938
	290	46	2.1	2.1	215		413	640	2000	2600	NU1038M
	290	46	2.1	2.1	215		435	600	2000	2600	NJ1038Q1/HAP63
	340	55	4	4	231		710	980	1600	1900	NU238EM/C9
	340	55	4	4	231		620	885	1600	1900	NU238M
	340	55	4	4	231		620	885	1600	1900	NJ238M
	340	55	4	4	231		620	885	1600	1900	NUP238M
	340	55	4	4		306	710	980	1600	1900	N238EM
	340	55	4	4	230		710	980	1600	1900	NU238EM-DT
	340	92	4	4	228		1140	1750	1600	1900	NU2238M
	340	92	4	4	228		1210	1660	1600	1900	NJ2238EM
	340	120	4	4	231		1320	2340	1600	1900	NU3238M/C3
	400	78	5	5	245		1040	1370	1200	1500	NJ338M
	400	78	5	5	245		1040	1370	1200	1500	NU338M
	400	78	5	5		345	1040	1730	1200	1500	N338M
400	132	5	5	240		1870	2450	1200	1500	NU2338EMA	
400	132	5	5	245		1560	2300	1200	1500	NU2338M	

Abutment and fillet dimensions						Weight	Model	Weight	Separate thrust collar			
d <sub>amin</sub>	d <sub>amax</sub>	d <sub>bmin</sub>	D <sub>amax</sub>	D <sub>amin</sub>	r <sub>amax</sub>				r <sub>bmax</sub>	A1	A2	r <sub>3,4</sub>
mm						kg	kg	mm				
196	211	218	304		3	3	31.4					
196	211	218	304		3	3	30.3	HJ2236E1.94	12	23.67	4	
196	211	232	304		3	3	31.9					
196	211	232	304		3	3	31.0	HJ2236E1.94	12	23.67	4	
196	211	232	304		3	3	31.7					
196	211	232	304		3	3	32.1					
196	211	218	304		3	3	41.6					
196	211	218	304		3	3	41.6					
196	325	364		335	3	3	39.6					
196	226	236	364		3	3	42.8	HJ336	3.1	17	29.16	4
196	226	236	364		3	3	43.6	HJ336	3.1	17	29.16	4
196	226	254	364		3	3	42.7					
196	226	236	364		3	3	42.1					
196	226	236	364		3	3	43.3					
196	227	255	364		3	3	72.0					
196	227	236	364		3	3	69.5					
196	206	210	252		1.5	1	6.98					
196	206	210	252		1.5	1	7.24					
201	212	218	279		2	2	10.9					
201	212	218	279		2	2	11.2					
206	226	234	324		3	3	22.8					
206	226	234	324		3	3	21.6	HJ238	2.04	13	23.13	4
206	226	248	324		3	3	22.0	HJ238	2.04	13	23.13	4
206	226	248	324		3	3	22.3					
206	236	324			3	3	22.6					
206	226	234	324		3	3	22.5					
206	223	232	324		3	3	38.6					
206	232	218	324		3	3	39.6					
206	223	232	324		3	3	51.2					
206	240	266	380		4	4	49.4	HJ338	4.3	18	31.65	5
210	240	249	380		4	4	48.5	HJ338	4.3	18	31.65	5
210	340	380	350		4	4	50.2					
210	235	249	380		4	4	82.8					
210	230	380			4	4	82.9					