

Single-row Cylindrical Roller Bearing

d 75-80 mm

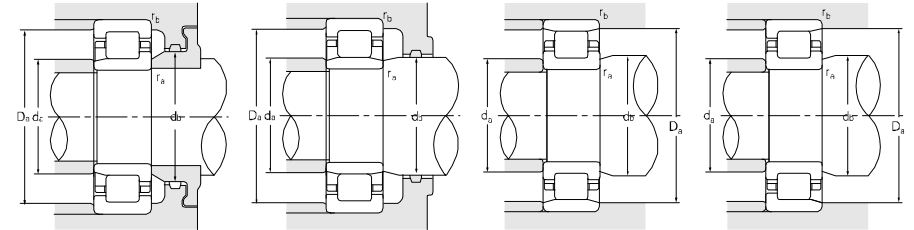
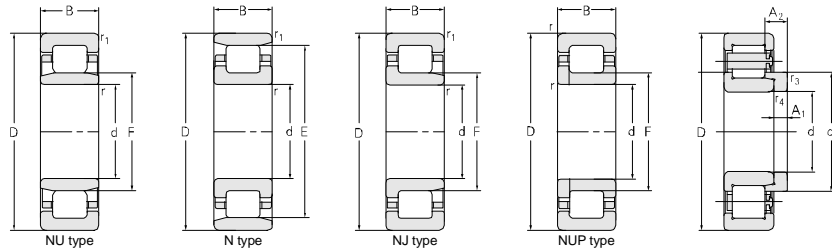

Principal dimensions							Basic load ratings		Limit speed ratings		Designations
d	D	B	r _{1smin}	r _{smin}	F	E	C _r	C _{0r}	Grease	Oil	
mm							kN		r/min		
75	130	31	1.5	1.5	88.5		164	211	4500	4500	NU2215ETN1/C9
	130	31	1.5	1.5	88.5		132	166	4500	5300	NU2215M
	130	31	1.5			116.5	132	166	4500	5300	N2215M
	130	31		1.5	88.5		132	166	4500	5300	NUP2215TN1
	130	41.28	1.5	1.5	89		204	268	4000	4000	NU5215XPC3
	130	41.28	1.5	3	89		204	268	4000	4000	NU3215X2M/C9YA6
	160	37	2.1	2.1	95.5		204	226	3400	4000	NJ315Q1
	160	37	2.1	2.1		139.5	269	254	3400	4000	N315EM
	160	37	2.1	2.1		139.5	204	226	3400	4000	N315J
	160	37	2.1	2.1	95		269	254	3400	4000	NU315EM
	160	37	2.1	2.1	95.5		204	226	3400	4000	NU315Q1
	160	37	2.1	2.1		143	269	254	3400	4000	N315E
	160	37	2.1	2.1	95		269	254	3400	4000	NU315ETN1
	160	37	2.1	2.1	95		269	254	3400	4000	NU315ENM
	160	37	2.1	2.1	95		269	254	3400	4000	NUP315EM
	160	37	2.1	2.1		139.5	255	226	3400	4000	N315M
	160	37	2.1	2.1	95.5		255	226	3400	4000	NU315M
	160	37	2.1	2.1	95		269	254	3400	4000	NU315E
	160	37	2.1	2.1	95.5		255	226	3400	4000	NJ315M
	160	46	2.1	2.1	95		269	303	3400	4000	NJ315X2EM/YAB
	160	37	2.1	2.1	95		269	254	3400	4000	NJ315E
	160	55	2.1	2.1		139.5	287	345	3400	4000	N2315M
	160	55	2.1	2.1		139.5	287	345	3400	4000	N2315Q1
	160	55	2.1	2.1	95.5		287	345	3400	4000	NJ2315M
160	55	2.1	2.1	95.5		287	345	3400	4000	NU2315M	
190	45	3	3	104.5		300	325	3400	5300	NJ415M	
190	45	3	3	104.5		300	325	3400	5300	NJ415M/YA8	
190	45	3	3		160.5	300	325	3400	4000	N415M	
190	45	3	3	104.5		300	325	3400	4000	NU415M	
80	125	22	1.1	1	113.5	95	122	5300	6300		N1016M
	125	22	1.1	1	91.5	95	122	5300	6300		NU1016M
	140	26	2	2		125	127	154	4000	4800	NF216M
	140	26	2	2		125	127	154	4000	4800	N216M
	140	26	2	2	95	127	154	4000	4800		NJ216M
	140	26	2	2	95	127	154	4000	4800		NU216M

Abutment and fillet dimensions							Weight	Model	Weight	Separate thrust collar		
d _{amin}	d _{amax}	d _{bmin}	D _{amax}	D _{amin}	r _{amax}	r _{bmax}				A1	A2	r _{3,4}
mm							kg	kg	mm			
83		97	122		1.5	1.5	1.54					
83	86	91	122		1.5	1.5	1.75					
83	86		122	121	1.5	1.5	1.77					
83		97	122		1.5	1.5	1.83					
81.5	92	91	123.5		1	1	2.27					
81.5	92	91	123.5		1	1	2.27					
86	137	107	149	142	2	2	3.75					
86	140		149	146	2	2	3.65					
86	92		149		2	2	3.28					
86	92	97	149		2	2	3.62					
86	92	97	149		2	2	3.68					
86	140		149	146	2	2	3.59					
86	92	97	149		2	2	3.25					
86	92	97	149		2	2	3.59					
86		107	149		2	2	3.75					
86	140		149	146	2	2	3.59					
86	92	97	149		2	2	3.56					
86	92	97	149		2	2	3.56					
86	92	107	149		2	2	3.63					
86	92	107	149		2	3	4.62					
86	157	107	149	163	2	2	3.64					
86	136		149	143	2	2	5.30					
86	136		149	143	2	2	5.84					
86	91	107	149		2	2	5.86	HJ2315	0.512	11	21.8 2.1	
86	91	98	149		2	2	5.96	HJ2315	0.512	11	21.8 2.1	
88	87	119	177		2.5	2.5	7.14					
88	87	119	177		2.5	2.5	7.20					
88	101		177		2.5	2.5	6.86					
88	101	107	177		2.5	2.5	6.94					
85	110		118.5	116.5	1	1	1.00					
	85	90	118.5		1	1	1.21					
	89		131		2	2	1.72					
	89	123		131	128	2	2	1.66				
	89	93	104	131		2	2	1.73				
	89	93	98	131		2	2	1.69				