

Self-aligning Ball Bearing

d 75-100 mm

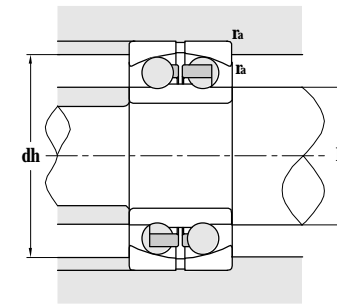
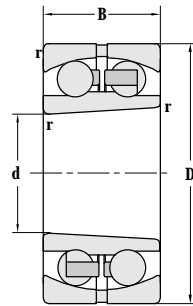
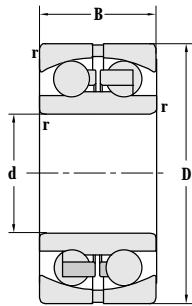

Principal dimensions				Basic load ratings		Limit speed ratings		Designations	
d	D	B	r <sub>min</sub>	C <sub>r</sub>	C <sub>or</sub>	Grease	Oil	Cylindrical bore	Tapered bore
mm				kN		r/min			
<b>75</b>	130	25	1.5	39.0	15.5	4800	5600	<b>1215</b>	<b>1215K</b>
	130	31	1.5	55.5	21.3	4500	5300	<b>2215</b>	<b>2215K</b>
	160	37	2.1	79.5	29.9	3800	4500	<b>1315</b>	<b>1315K</b>
	160	55	2.1	123	43.0	3400	4000	<b>2315</b>	<b>2315K</b>
	160	55	2.1	123	43.0	3400	4000	<b>2315TN1</b>	
<b>80</b>	140	26	2	40.0	16.9	4500	5300	<b>1216</b>	<b>1216K</b>
	140	26	2	40.0	16.9	4500	5300	<b>1216TN1</b>	<b>1216KTN1</b>
	140	33	2	63.0	24.7	4000	4800	<b>2216</b>	<b>2216K</b>
	170	39	2.1	89.0	33.5	3600	4300	<b>1316</b>	<b>1316K</b>
	170	58	2.1	131	47.5	3200	3800	<b>2316</b>	<b>2316K</b>
	170	58	2.1	131	47.5	3200	3800	<b>2316TN1</b>	
	170	58	2.1	131	47.5	3200	3800	<b>2316M</b>	
<b>85</b>	150	28	2	49.0	20.5	4000	4800	<b>1217</b>	<b>1217K</b>
	150	36	2	58.5	23.6	3800	4500	<b>2217</b>	<b>2217K</b>
	180	41	3	98.5	38.0	3400	4000	<b>1317</b>	<b>1317K</b>
	180	60	3	139	51.5	3000	3600	<b>2317</b>	<b>2317K</b>
<b>90</b>	160	30	2	57.0	23.4	3800	4500	<b>1218</b>	<b>1218K</b>
	160	40	2	70.0	28.5	3400	4300	<b>2218</b>	<b>2218k</b>
	190	43	3	117	45.0	3200	3800	<b>1318</b>	<b>1318K</b>
	190	43	3	118	45.1	3200	3800	<b>1318M</b>	
	190	64	3	151	57.0	2800	3400	<b>2318</b>	<b>2318k</b>
	190	64	3	152	57.1	2800	3400	<b>2318M</b>	<b>2318KM</b>
<b>95</b>	170	32	2.1	64.0	27.0	3600	4300	<b>1219</b>	<b>1219K</b>
	170	43	2.1	83.5	34.0	3400	4000	<b>2219</b>	<b>2219K</b>
	200	45	3	132	51.0	3000	3600	<b>1319</b>	<b>1319k</b>
	200	67	3	164	64.5	2600	3200	<b>2319</b>	<b>2319K</b>
<b>100</b>	180	34	2.1	69.0	29.5	3400	4000	<b>1220</b>	<b>1220K</b>
	180	34	2.1	69.1	29.5	3400	4000	<b>1220M</b>	<b>1220KM</b>
	180	46	2.1	97.5	40.5	3200	3800	<b>2220</b>	<b>2220K</b>
	180	46	2.1	97.6	40.6	3200	3800	<b>2220M</b>	<b>2220KM</b>
	215	47	3	143	58.0	2800	3400	<b>1320J</b>	<b>1320KJ</b>

Abutment and fillet dimensions			Axle load coefficient			Weight		
D <sub>smin</sub>	dh <sub>max</sub>	r <sub>amax</sub>	e	Y1	Y2	Y0	Cylindrical bore	Tapered bore
mm			mm			kg		
83	122	1.5	0.17	3.6	5.58	3.77	1.35	1.31
83	122	1.5	0.25	2.49	3.86	2.61	1.71	1.64
86	149	2	0.22	2.84	4.39	2.97	3.55	3.45
86	149	2	0.38	1.66	2.56	1.73	4.71	4.51
86	149	2	0.38	1.66	2.56	1.73	4.71	4.51
89	131	2	0.16	3.94	6.1	4.13	1.65	1.60
89	131	2	0.16	3.94	6.1	4.13	1.59	1.54
89	131	2	0.25	2.49	3.86	2.61	2.19	2.11
91	159	2	0.22	2.92	4.52	3.06	4.19	4.09
91	159	2	0.39	1.63	2.53	1.71	5.70	5.50
91	159	2	0.39	1.63	2.53	1.71	5.62	5.42
91	159	2	0.39	1.63	2.53	1.71	5.93	5.73
94	141	2	0.17	3.69	5.7	3.86	2.10	2.04
94	141	2	0.25	2.48	3.84	2.6	2.53	2.43
98	167	2.5	0.22	2.9	4.49	3.04	4.95	4.81
98	167	2.5	0.38	1.67	2.59	1.75	6.73	6.43
99	151	2	0.17	3.76	5.81	3.94	2.44	2.36
99	151	2	0.27	2.36	3.65	2.47	3.22	3.08
103	177	2.5	0.22	2.81	4.35	2.94	5.99	5.82
103	177	2.5	0.22	2.81	4.35	2.94	6.70	6.40
103	177	2.5	0.38	1.67	2.58	1.74	8.27	7.97
103	177	2.5	0.38	1.67	2.58	1.74	8.45	8.15
106	159	2	0.17	3.68	5.69	3.85	3.06	2.96
106	159	2	0.26	2.38	3.69	2.5	5.38	5.20
108	187	2.5	0.23	2.77	4.29	2.9	6.98	6.80
108	187	2.5	0.38	1.68	2.59	1.76	9.20	8.80
111	169	2	0.17	3.64	5.63	3.81	3.68	3.58
111	169	2	0.17	3.64	5.63	3.81	3.78	3.68
111	169	2	0.27	2.34	3.62	2.45	4.95	4.74
111	169	2	0.27	2.34	3.62	2.45	5.15	4.95
113	202	2.5	0.24	2.67	4.13	2.8	9.14	8.94