

Single-row Cylindrical Roller Bearing

d 95-100 mm

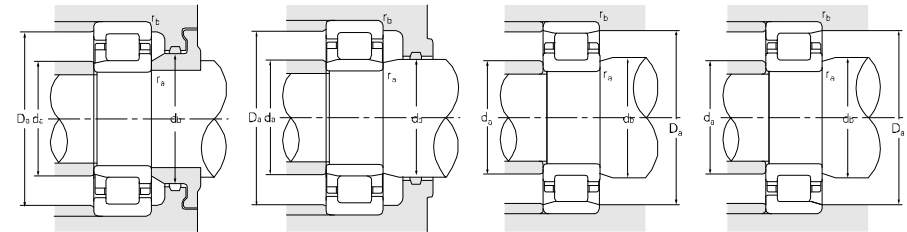
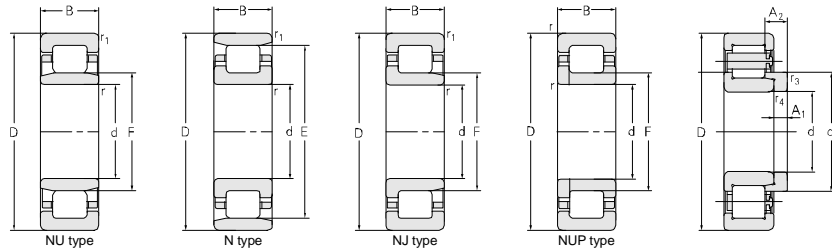

	Principal dimensions						Basic load ratings		Limit speed ratings		Designations
	d	D	B	r _{1smin}	r _{smin}	F	E	C _r	C _{Or}	Grease	
mm							kN	r/min			
95	200	67	3	3		177.5	510	560	2600	3200	N2319E
	240	55	4	4		201.5	455	525	2600	3200	N419M
	240	55	4	4	133.5		455	525	2600	3200	NU419M
	240	55	4	4	133.5		455	525	2600	3200	NJ419M
	240	55	4	4	133.5		455	525	2600	3200	NUP419M
99.5	180	46	2.1	2.1	120		275	385	3200	3800	NJ2220X4M/P63
100	140	20	1.1	1.1	110		75.5	110	3600	4300	NU1920M
	150	24	1.5	1.1	113		94.5	125	3600	4300	NJ1020M
	180	34	2.1	2.1		160	208	256	3200	3800	N220M
	180	34	2.1	2.1		160	208	256	3200	3800	NF220M
	180	34	2.1	2.1	120		208	256	3200	3800	NJ220M
	180	34	2.1	2.1	120		208	256	3200	3800	NU220M
	180	34	2.1	2.1	120		208	256	3200	3800	NU220M/W124
	180	34	2.1	2.1	120		208	256	3200	3800	NU220Q1
	180	34	2.1	2.1		163	275	330	3200	3800	N220E
	180	34	2.1	2.1		163	275	330	3200	3800	N220ETN1
	180	34	2.1	2.1	119		275	330	3200	3800	NU220E
	180	34	2.1	2.1	119		275	330	3200	3800	NU220ETN1
	180	34	2.1	2.1	119		275	330	3200	3800	NU220ETN1/C9
	180	34	2.1	2.1	119		275	330	3200	3800	NJ220E
	180	34	2.1	2.1	119		275	330	3200	3800	NJ220ETN1
	180	34	2.1	2.1	119		275	330	3200	3800	NUP220E
	180	34	2.1	2.1	119		275	330	3200	3800	NUP220ETN1
	180	34	2.1	2.1	120		231	240	3200	3800	NUP220M
	180	34	2.1	2.1	120		195	240	3200	3800	NU220M-DT
	180	46	2.1	2.1		160	275	385	3200	3800	N2220M
	180	46	2.1	2.1	120		275	385	3200	3800	NUP2220M
	180	46	2.1	2.1	120		275	385	3200	3800	NJP2220M/P63
	180	46	2.1	2.1	120		275	385	3200	3800	NJ2220M
	180	46	2.1	2.1	120		275	385	3200	3800	NU2220M
	180	46	2.1	2.1	119		365	470	3200	3800	NU2220E
	180	46	2.1	2.1	119		365	470	3200	3800	NU2220ETN1
	180	60.3	2.1	2.1	120		208	256	3200	3800	NU3220M/C3
180	60.3	2.1	2.1	119		335	440	3200	3800	NJP3220TN1/HG2P54	

Abutment and fillet dimensions							Weight	Model	Weight	Separate thrust collar		
d _{amin}	d _{amax}	d _{bmin}	D _{amax}	D _{amin}	r _{amax}	r _{bmax}				A1	A2	r _{3,4}
mm							kg	kg	mm			
108	116		187	181	2.5	2.5	9.76					
111	198		224	205	3	3	13.3					
111	130	136	224		3	3	13.6	HJ419	1.35	15	25.23	4
111	130	150	224		3	3	13.9	HJ419	1.35	15	25.23	4
111		150	224		3	3	14.2					
111	116	130	169		2	2	5.42					
102	107	118	133		1	1	0.900					
105	110	123	132		1	1	1.51					
111	157		169	163	2	2	3.45					
111			169	163	2	2	3.55					
111	116	130	169		2	2	3.61					
111	116	123	169		2	2	3.52					
111	116	123	169		2	2	3.52					
111	116	123	169		2	2	3.57					
111	160		169	166	2	2	3.77					
111	160		169	166	2	2	3.75					
111	116	122	169		2	2	3.75					
111	116	122	169		2	2	3.39					
111	116	122	169		2	2	3.39					
111	116	130	169		2	2	3.81					
111	116	130	169		2	2	3.45					
111		130	169		2	2	3.90					
111		130	169		2	2	3.54					
112		130	168		2	2	3.71					
111	116	123	169		2	2	3.03					
111	116		169	166	2	2	5.25					
111	116	130	169		2	2	5.49					
111	116	130	169		2	2	5.38					
111	116	130	169		2	2	5.86					
111	116	122	169		2	2	5.20					
111	116	122	169		2	2	5.08					
111	116	122	169		2	2	4.69					
121	140	147	244		3	3	6.81					
121	140	147	244		3	3	5.98					