

Single-row Cylindrical Roller Bearing

d 105~110 mm

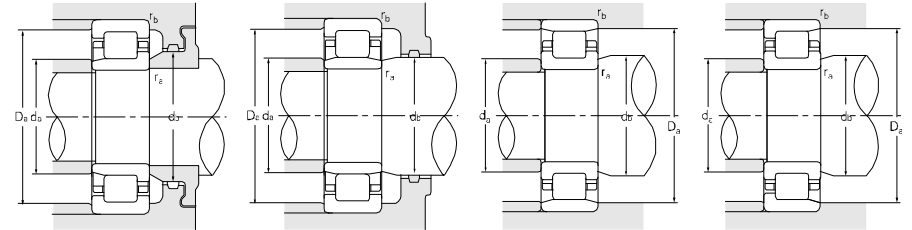
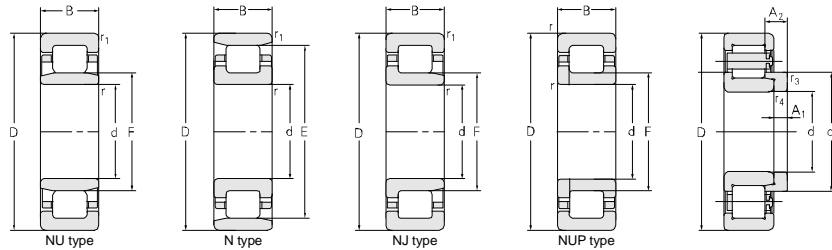

Principal dimensions						Basic load ratings		Limit speed ratings		Designations	
d	D	B	r _{1smin}	r _{smin}	F	E	C _r	C _{0r}	Grease		Oil
mm						kN		r/min			
105	160	26	2	1.1	145.5	120	170	4000	4800	NF1021M	
	160	26	2	1.1	145.5	120	170	4000	4800	N1021M	
	190	36	2.1	2.1	168.8	225	285	3000	3600	N221M	
	190	36	2.1	2.1	126.8	225	285	3000	3600	NJ221M	
	190	36	2.1	2.1	126.8	225	285	3000	3600	NU221M/W124	
	190	36	2.1	2.1	125	290	315	3000	3600	NJ221EM	
	190	36	2.1	2.1	125	290	315	3000	3600	NU221EM/C9	
	190	36	2.1	2.1	125	290	315	3000	3600	NU221EM	
	190	65.1	2.1	2.1	126.8	350	500	3000	3600	NU3221M/C3	
	225	49	3	3	201	480	525	2200	2800	N321EM	
	225	49	3	3	133	480	525	2200	2800	NJ321EM	
	225	49	3	3	133	480	525	2200	2800	NU321EM	
	225	49	3	3	133	480	525	2200	2800	NU321EM/C9	
	225	87.3	3	3	196	660	910	2200	2800	N3321	
	260	60	4	4	220.5	560	655	2200	2800	N421M	
	260	60	4	4	144.5	560	655	2200	2800	NU421M	
	260	60	4	4	144.5	560	655	2200	2800	NJ421M/C5	
107.95	165.1	57.15	2.5	2.5	127	285	590	3000	3600	NA6/107X4/C9	
110	170	28	2	1.1	155	140	195	3800	4500	N1022M	
	170	28	2	1.1	125	140	195	3800	4500	NU1022M	
	170	28	2	1.1	125	140	195	3800	4500	NJ1022M	
	170	28	2	1.1	125	140	195	3800	4500	NUP1022M	
	170	28	2	1.1	125	140	195	3800	4500	NUP1022TN1/C9YB2	
	200	38	2.1	2.1	178.5	255	315	2800	3400	N222J	
	200	38	2.1	2.1	132.5	255	315	2800	3400	NU222M/YA8	
	200	38	2.1	2.1	132.5	255	315	2800	3400	NU222Q1	
	200	38	2.1	2.1	178.5	255	315	2800	3400	NF222M	
	200	38	2.1	2.1	178.5	270	335	2800	3400	N222M	
	200	38	2.1	2.1	132.5	270	335	2800	3400	NJ222M	
	200	38	2.1	2.1	132.5	270	335	2800	3400	NU222M/W124	
	200	38	2.1	2.1	132.5	270	335	2800	3400	NU222M	
	200	38	2.1	2.1	132.5	320	350	2800	3400	NU222EM/C9	
	200	38	2.1	2.1	180.5	320	350	2800	3400	N222EM	
	200	38	2.1	2.1	132.5	320	350	2800	3400	NJ222EM	

Abutment and fillet dimensions							Weight	Model	Weight	Separate thrust collar		
d _{amin}	d _{amax}	d _{bmin}	D _{amax}	D _{amin}	r _{amax}	r _{bmax}				A1	A2	r _{3,4}
mm							kg	kg	mm			
111.5	141		151	149	2	1	1.93					
111.5	166		151	149	2	1	1.85					
116	121		179	172	2	2	4.33					
116	198	137	179		2	2	4.34					
116	198	137	179		2	2	4.25					
116	198	137	179		2	2	4.52					
116	198	137	179		2	2	4.42					
116	198	137	179		2	2	4.33					
116	122	128	179		2	2	8.22					
118	130		212	203	2.5	2.5	10.5					
118	130	148	212		2.5	2.5	10.7					
118	217	136	212		2.5	2.5	10.6					
118	217	136	212		2.5	2.5	10.6					
116	193		208	199	2.5	2.5	18.3					
121	151		244	224	3	3	17.2					
121	217	136	244		3	3	17.3					
121	217	136	244		3	3	17.6					
114	121	125	155		2	2	5.11					
116.5	123		161	157	2	1	2.31					
116.5	175	128	161		2	1	2.32					
116.5	175	128	161		2	1	2.39					
116		135	161		2	2	2.45					
116		135	161		2	2	2.17					
121	175		189	181	2	2	4.70					
121	129	135	189		2	2	5.30					
121	177	135	189		2	2	5.36					
121	129		189	181	2	2	5.17					
121	129		189	181	2	2	5.02					
121	129	145	189		2	2	5.10					
121	129	135	189		2	2	5.05					
121	129	135	189		2	2	5.05					
121	129		189	183	2	2	5.28					
121	129		189	183	2	2	5.27					
121	204	145	189		2	2	5.38					