

Matched Pair Angular Contact Ball Bearing

d 120~160 mm

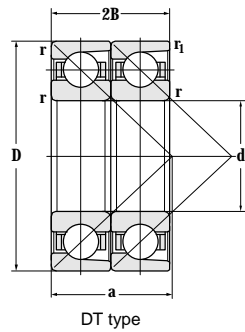

DT type

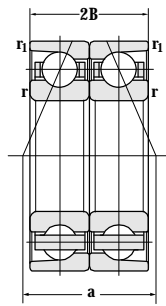

DB type

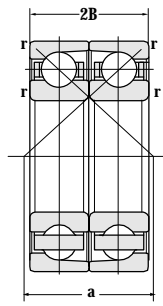

DF type

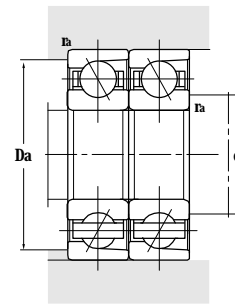

DT type

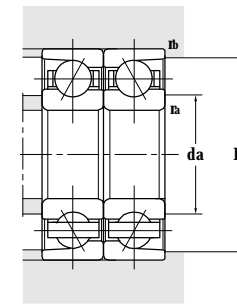

DB type

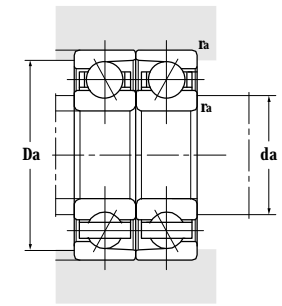

DF type

Principal dimensions					Basic load ratings		Limit speed ratings		Designations
d	D	2B	r	r ₁	C _r	C _{0r}	Grease	Oil	
mm					kN	r/min			
120	260	110	3	1.1	410	525	3300	4500	7324B/DT 7324AC/DB 7324B/DF
	260	110	3	1.1	430	540	1600	2200	
	260	110	3	3	405	525	1600	2200	
130	180	48	1.5	0.6	130	190	3400	4800	71926ACM/DT
	200	66	2	1	198	260	2600	3600	7026AC/DT
	200	63	2	1	126	179	2600	3600	SV7026X2ATYN/P4ADBA
	230	80	3	1.1	278	350	1800	2600	7226BM/P5DBCB
	230	80	3	1.1	320	400	1700	2400	7226ACM/DB
	230	80	3	3	320	400	1700	2400	7226ACM/DF
	280	116	4	-	403	537	1600	2200	7326B/DF
	280	116	4	1.5	403	537	1600	2200	7326B/DT
	280	116	4	1.5	455	605	1500	2000	7326ACM/DB
	230	80	3	1.1	278	350	1800	2600	7226BM/DT
	230	80	3	1.1	278	350	1800	2600	7226BM/DF
	230	80	3	1.1	335	420	1900	2800	7226C/P4DFA
140	210	66	2	-	203	275	3600	4800	7028AC/DF
	250	84	3	1.1	355	470	1600	2200	7228ACM/DB-SH
	250	84	3	1.1	309	414	1700	2300	7228BM/DB
	250	84	3	1.1	309	414	1700	2300	7228BM/DT
	250	84	3	1.1	310	415	1700	2300	7228BM/P5DBCB
	300	124	4	1.5	447	616	1600	2000	7328B/DT
	300	124	4	1.5	445	600	1600	2000	7328BA/DT
	300	124	4	1.5	445	600	1400	1900	7328B/DB
	300	124	4	4	445	600	1400	1900	7328B/DF
	150	225	70	2.1	1.1	213	294	1700	2300
225		67.5	2.1	1.1	213	194	1600	2200	7030X2BM/P4ADBA
270		90	3	-	310	430	1600	2000	7230B/DF
270		90	3	1.1	582	857	1500	2000	7230BM/DB
320		130	4	-	582	856	2600	3600	7330AC/DF
320		130	4	-	582	856	2600	3600	7330B/DF
160		229.5	66	3	1.5	151	256	3000	4000
	240	76	2.1	1.1	225	315	3100	4100	7032BM/DB

Contact points			Abutment and fillet dimensions					Weight
DB	DF	DT	d _{amin}	D _{amax}	D _{bmax}	r _{amax}	r _{bmax}	
			mm					kg
-	-	107.2	134	246	-	2.5	-	29.2
107	107	-	134	246	-	2.5	1	27.4
-	-	-	134	246	-	2.5	1	29.2
96.3	-	-	-	-	174	-	1	3.78
-	-	-	-	-	194	-	1	6.75
-	-	-	-	-	194	-	1	6.76
191	-	-	144	-	216	2.5	1	15.1
96	-	-	144	216	-	2.5	1	14
-	96	-	144	216	-	2.5	1	14
-	114	-	148	262	-	3	-	35.9
-	-	115.1	148	262	-	3	-	35.9
115	-	-	147	263	-	3	1.5	36.1
-	-	171	152	209	-	2.5	1	15.1
111	-	-	152	209	-	2.5	1	15.1
-	8	-	148	213	-	2.5	1	12.5
-	48.6	-	150	200	-	2	-	6.92
103	-	-	154	236	-	2.5	1	16.9
205.8	-	-	154	-	243	2.5	1	17.2
-	-	184.8	154	228	-	2.5	1	17.2
205.6	-	-	154	-	243	2.5	1	17.2
-	-	123.2	158	282	-	3	-	42.3
-	-	123	158	282	-	3	-	42.3
123	-	-	157	283	-	3	1.5	42.3
-	123	-	157	283	-	3	1.5	42.3
192.3	-	-	160	-	215	2	1	9.61
96	-	-	160	215	-	2	1	9.57
-	132	-	165	256	-	2.5	-	22
111	-	-	164	256	2.5	23.7	-	23.4
-	45.3	-	168	302	-	3	-	51.6
-	132	-	168	302	-	3	-	52.3
78.9	-	-	172	-	214	2	1	9.06
205.8	-	-	172	-	233	2	1	12