

Single-row Cylindrical Roller Bearing

d 80 mm

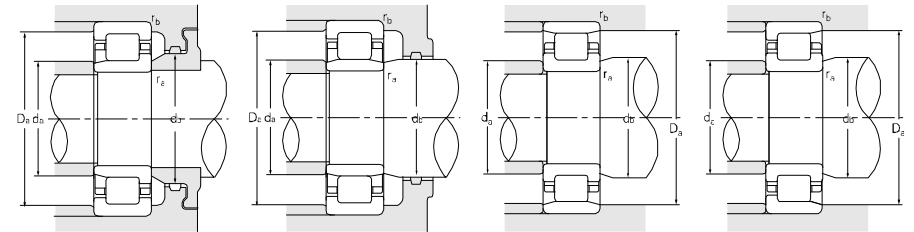
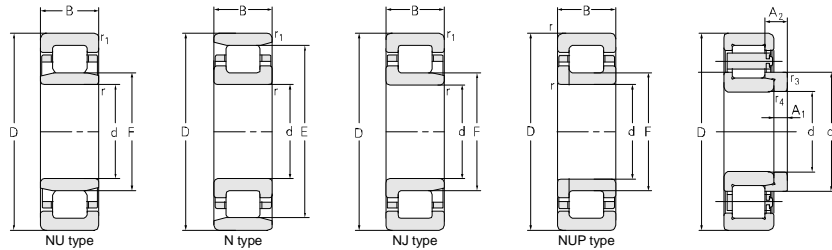

Principal dimensions						Basic load ratings		Limit speed ratings		Designations	
d	D	B	r _{1smin}	r _{smin}	F	E	C _r	C _{0r}	Grease		Oil
mm						kN		r/min			
80	140	26		2	95		127	154	4000	4800	NUP216M
	140	26	2	2	95.3		151	184	4000	4800	NU216E
	140	26	2	2	95.3		135	170	4000	4800	NU216Q1
	140	26	2	2	95.3		151	184	4000	4800	NU216ETN1/C9
	140	26		2	95.3		151	184	4000	4800	NUP216E
	140	26	2	2		127.3	151	184	4000	4800	N216E
	140	26	2	2	95.3		151	184	4000	4800	NJ216E
	140	26		2	95.3		160	184	4000	4800	NUP216ENR/J/C3YA6
	140	26		2	95.3		160	184	4000	4800	NUP216ENRM/YA6
	140	26	2	2	95		120	144	4000	4800	NU216M-DT
	140	33	2	2	59.3		152	195	4000	4800	NU2216M
	140	33	2	2	95.3		152	226	4000	4800	NJ2216M
	140	33	2	2	95.3		204	235	4000	4800	NU2216EM
	140	33	2	2	95.3		204	235	4000	4800	NJ2216E
	140	33	2	2	95.3		204	235	4000	4800	NU2216E
	140	33	2	2		127.3	204	235	4000	4800	N2216E
	140	33		2	95.3		204	235	4000	4800	NUP2216E
	140	44.5	2	2	95.28		220	305	4000	4800	NU5216
	140	44.5	2	2	95.28		210	290	4000	4800	NU3216X2M/C9YA6
	150	45	2	2	97		245	320	3800	4500	NJ3216X3M/P54
	150	45	2	2	97		245	320	3800	4500	NJP3216X3M/P54
	170	39	2.1	2.1		151	217	246	3200	3800	N316M
	170	39	2.1	2.1		151	217	246	3200	3800	NF316M
	170	39	2.1	2.1	103		217	246	3200	3800	NU316M
	170	39	2.1	2.1	103		217	246	3200	3800	NU316Q1
	170	39	2.1	2.1	103		217	246	3200	3800	NJ316M
	170	39	2.1	2.1	103		217	246	3200	3800	NUP316M
	170	39	2.1	2.1	101		288	278	3200	3800	NJ316EM
	170	39	2.1	2.1		151	288	278	3200	3800	N316EM
	170	39	2.1	2.1	101		288	278	3200	3800	NU316EM
	170	39	2.1	2.1	101		288	278	3200	3800	NU316EF1/C9
	170	39	2.1	2.1		151	288	278	3200	3800	N316E
	170	39	2.1	2.1	101		288	278	3200	3800	NJ316E
	170	39	2.1	2.1	101		288	278	3200	3800	NU316E
	170	39	2.1	2.1	101		288	278	3200	3800	NU316ETN1
	170	58	2.1	2.1		147	305	380	3200	3800	N2316M

Abutment and fillet dimensions						Weight	Model	Weight	Separate thrust collar		
d _{amin}	d _{amax}	d _{bmin}	D _{amax}	D _{amin}	r _{amax}				r _{bmax}	A1	A2
mm						kg	kg	mm			
89		104	131		2	2	1.77				
89	93	98	131		2	2	1.65				
89	93	98	131		2	2	1.74				
89	93	98	131		2	2	1.48				
89		104	131		2	2	1.72				
89	125	104	131	130	2	2	1.67				
89	93	104	131		2	2	1.68				
89		104	131		2	2	1.66				
89		104	131		2	2	1.81				
89	93	98	131		2	2	1.65				
89	93	98	131		2	2	2.32				
89	93	104	131		2	2	2.35				
89	93	98	131		2	2	2.39				
89	93	104	131		2	2	2.34				
89	93	98	131		2	2	2.30				
89	124	131	130		2	2	2.16				
89		104	131		2	2	2.13				
88	93	97	132		1.5	1.5	3.03				
88	93	97	132		1.5	1.5	3.03				
90	94	104	136		2	2	3.69				
90	94	104	136		2	2	3.69				
91	144	159			2	2	4.30				
91	144	159			2	2	4.46				
91	100	106	159	150	2	2	4.37				
91	100	106	159		2	2	4.45				
91	98	113	159		2	2	4.47				
91		113	159		2	2	4.58				
91	98	113	159		2	2	4.32				
91	148	159		154	2	2	4.22				
91	98	104	159		2	2	4.26				
91	98	104	159		2	2	4.20				
91	148	159		154	2	2	3.98				
91	98	113	159	154	2	2	4.08				
91	98	104	159		2	2	4.25				
91	98	104	159		2	2	3.89				
91	144	159			2	2	6.15				