

Single-row Cylindrical Roller Bearing

d 45-50 mm

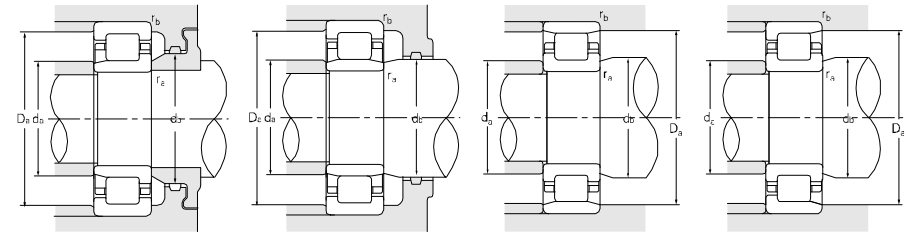
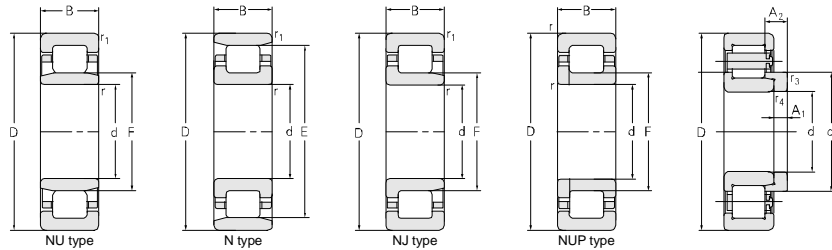

Principal dimensions						Basic load ratings		Limit speed ratings		Designations	
d	D	B	r _{1smin}	r _{smin}	F	E	C _r	C _{0r}	Grease		Oil
mm						kN		r/min			
45	85	23	1.1	1.1	54.5		82	78	5600	6700	NJ2209E/C3
	85	23	1.1	1.1	54.5		82	78	5600	6700	NJ2209EM
	85	30.16	1.1	1.1	55.52		94.6	119	6300	7500	NU3209X2M/C9YA6
	85	30.16	1.1	1.1	55.52		94.6	119	6300	7500	NU5209XPC3
	100	25	1.5	1.5		86.5	108	96	6300	7500	N309M
	100	25	1.5	1.5		86.5	108	96	6300	7500	N309J
	100	25	1.5	1.5		88.5	108	96	6300	7500	NCL309EN/YA
	100	25	1.5	1.5	58.5		108	96	6300	7500	NJ309ETN1
	100	25	1.5	1.5		88.5	108	96	6300	7500	NCL309E/YA
	100	25	1.5	1.5	58.5		108	96	6300	7500	NU309M/C3
	100	25	1.5	1.5	58.5		108	96	6300	7500	NJ309EM
	100	25	1.5	1.5		88.5	108	96	6300	7500	N309EM
	100	25	1.5	1.5	58.5		108	96	6300	7500	NUP309E
	100	25	1.5	1.5		88.5	108	96	6300	7500	N309E
	100	25	1.5	1.5		88.5	108	96	6300	7500	N309ETN1
	100	25	1.5	1.5		88.5	108	96	6300	7500	NF309E
	100	25	1.5	1.5	58.5		108	96	6300	7500	NJ309E
	100	25	1.5	1.5	58.5		108	96	6300	7500	NJ309EM/C4W124YA8
	100	25	1.5	1.5	58.5		108	96	6300	7500	NU309E
	100	25	1.5	1.5	56.4		108	96	6300	7500	NU309NRB1/YA6
	100	25	1.5	1.5	58.5		108	96	6300	7500	NUP309ETN1/HAC3YA6
	100	27.5	1.5	0.8	58.5		101	102	6300	7500	NUP309EWB1NRTN1
	100	31	1.5	1.5		88	119	120	6300	7500	NF2309X2J/YA6
	100	36	1.5	4.5	58.5		154	150	5600	6700	NU2309EM/C3
	100	36	1.5	1.5	58.5		154	150	5600	6700	NJ2309E
	100	31	1.5	1.5	58.5		141	153	5600	6700	NJ2309X2NV/C9YA26
	100	36	1.5	1.5	58.5		154	150	5600	6700	NJ2309EM
	100	36	1.5	1.5	58.5		154	150	5600	6700	NJ2309EM/C4W124
	100	36	1.5	1.5	58.5		154	150	5600	6700	NU2309E
	100.038	25	1.5	1.5		86.5	108	96	6300	7500	NF309X1MR/YA1
	120	29	2	2		100.5	124	123	5600	6700	N409M
	120	29	2	2	64.5		124	123	5600	6700	NU409M
	120	29	2	2	64.5		124	123	5600	6700	NJ409M
50	80	16	1	0.6	57.5		45	54	8500	10000	NJ1010M
	80	16	1	0.6	57.5		45	54	8500	10000	NJ1010TN1

Abutment and fillet dimensions						Weight	Model	Weight	Separate thrust collar		
d _{amin}	d _{amax}	d _{bmin}	D _{amax}	D _{amin}	r _{amax}				r _{bmax}	A1	A2
mm						kg	kg	mm			
51.5	53	61	78.5		1	1	0.639				
51.5	53	61	78.5		1	1	0.645				
51	53	58	79		1	1	0.831				
51	53	58	79		1	1	0.843				
53	84		92	90.5	1.5	1.5	0.920				
53	84		92	90.5	1.5	1.5	0.820				
53	84		92	90.5	1.5	1.5	0.872				
53	56	67	92		1.5	1.5	0.891				
53	84		92	90.5	1.5	1.5	0.872				
53	56	61	92		1.5	1.5	0.992				
53	56	67	92		1.5	1.5	1.00				
53	86		92	91	1.5	1.5	0.959				
53		67	92		1.5	1.5	1.01				
53	86		92	91	1.5	1.5	0.964				
53	86		92	91	1.5	1.5	0.846				
53			92	91	1.5	1.5	0.995				
53	56	67	92		1.5	1.5	1.01				
53	56	67	92		1.5	1.5	1.09				
53	56	61	92		1.5	1.5	0.986				
51	54	60	92		1.5	1.5	0.912				
53		67	92		1.5	1.5	0.892				
53		67	92		1.5	1.5	0.942				
53			92	91	1.5	1.5	1.12				
53	56	61	93		1	1	1.49				
53	56	67	92		1.5	1.5	1.45				
53	56	67	92		1.5	1.5	1.17				
53	56	67	92		1.5	1.5	1.52				
53	56	67	92		1.5	1.5	1.47				
53	56	61	93		1.5	1.5	1.42				
53	84		92	90.5	1.5	1.5	1.03				
54	97		111	103	2	2	1.67				
54	62	67	111		2	2	1.87				
54	62	74	111		2	2	1.88				
54	56	60	75		1	0.6	0.316				
54	56	60	75		1	0.6	0.279				