

Single-row Cylindrical Roller Bearing

d 110~120 mm

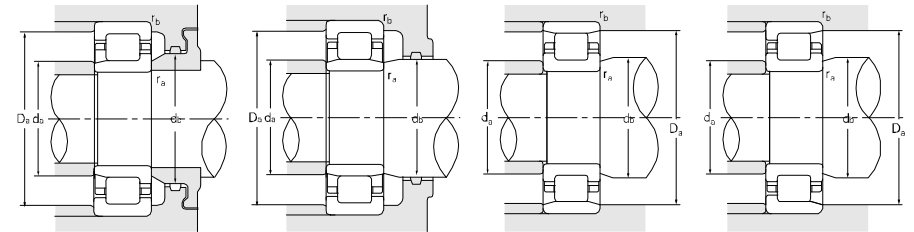
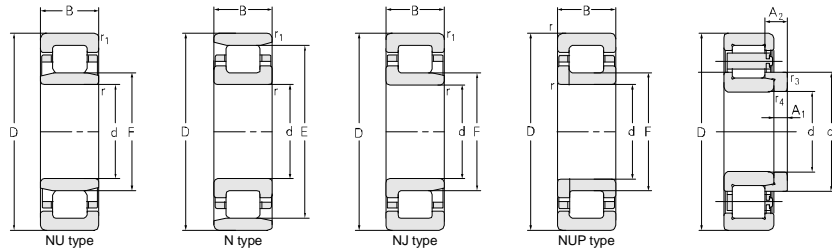

Principal dimensions						Basic load ratings		Limit speed ratings		Designations	
d	D	B	r _{1smin}	r _{smin}	F	E	C _r	C _{0r}	Grease		Oil
mm						kN		r/min			
110	200	38	2.1	2.1		180.5	320	350	2800	3400	N222E
	200	38	2.1	2.1	132.5		320	350	2800	3400	NU222E
	200	38	2.1	2.1	132.5		320	350	2800	3400	NJ222E
	200	53	2	2	132		352	470	2800	3400	NUP2222M
	200	53	2.1	2.1	132		352	470	2800	3400	NU2222M
	200	53	2.1	2.1	132		352	470	2800	3400	NJ2222M
	200	53	2	2	132		420	520	2800	3400	NU2222ETN1/C9
	200	69.8	2.1	2.1	132.5		450	655	2800	3400	NU3222M/C3
	240	50	3	3		207	410	480	2000	2600	N322
	240	50	3	3	143		410	480	2000	2600	NU322M-DT
	240	50	3	3		207	430	515	2000	2600	N322M
	240	50	3	3	143		430	515	2000	2600	NJ322M
	240	50	3	3	143		430	515	2000	2600	NU322M
	240	50	3	3	143		430	515	2000	2600	NU322Q1
	240	50	3	3	143		430	515	2000	2600	NUP322M
	240	50	3	3		211	510	520	2000	2600	N322EM
	240	50	3	3	143		510	520	2000	2600	NU322EM
	240	50	3	3	143		510	520	2000	2600	NU322ETN1/C9
	240	50	3	3	143		510	520	2000	2600	NU322EM/W124
	240	50	3	3		211	510	520	2000	2600	N322E
	240	50	3	3	143		510	520	2000	2600	NJ322E
	240	50	3	3	143		510	520	2000	2600	NU322E
	240	50	3	3	143		510	520	2000	2600	NU322EQ1/C9
	240	80	3	3	143		750	865	2000	2600	NU2322EQ1
	240	80	3	3	143		750	865	2000	2600	NJ2322EM/YA8
	240	80	3	3	143		750	865	2000	2600	NJ2322EM
	240	80	3	3	143		750	865	2000	2600	NU2322EM
	240	80	3	3	143		750	865	2000	2600	NU2322M/C9
	240	80	3	3	143		750	865	2000	2600	NU2322E
	240	80	3	3		211	750	865	2000	2600	N2322E
	240	80	3	3	143		750	865	2000	2600	FL-NU2322EM/P6
	280	65	4	4		235	615	725	2000	2600	N422M
280	65	4	4			615	725	2000	2600	NU422M	
280	65	4	4			615	725	2000	2600	NJ422M	
120	160	27	1.1	1.1	152	105	170	3400	4000	NF2924X1M	

Abutment and fillet dimensions							Weight	Model	Weight	Separate thrust collar		
d _{amin}	d _{amax}	d _{bmin}	D _{amax}	D _{amin}	r _{amax}	r _{bmax}				A1	A2	r _{3,4}
mm							kg	kg	mm			
121	177		189	183	2	2	5.11					
121	129	135	189		2	2	5.12					
121	204	145	189		2	2	5.02					
121		145	189		2	2	7.95					
121	129	135	189		2	2	7.63					
121	138	145	189		2	2	7.83					
121		145	189		2	2	6.57					
121	129	135	189		2	2	9.92					
123	208		227	210	2.5	2.5	10.2					
123	139	146	227		2.5	2.5	11.6	HJ322E	1.25	14	22	
123	139		227	210	2.5	2.5	11.4				3	
123	139	159	227		2.5	2.5	11.8					
123	139	146	227		2.5	2.5	11.6					
123		146	227		2.5	2.5	11.6					
123	230	159	227		2.5	2.5	10.3					
123	204		227	215	2.5	2.5	11.4					
123	139	146	227		2.5	2.5	11.5	HJ322E	1.25	14	22	
123	139	146	227		2.5	2.5	10.4	HJ322E	1.25	14	22	
123	139	146	227		2.5	2.5	11.5	HJ322E	1.25	14	22	
123	204		227	215	2.5	2.5	11.2					
123	139	159	227		2.5	2.5	11.4	HJ322E	1.25	14	22	
123	139	146	227		2.5	2.5	11.3	HJ322E	1.25	14	22	
123	139	146	227		2.5	2.5	11.8	HJ322E	1.25	14	22	
123	138	146	227		2.5	2.5	17.6	HJ2322E	1.31	14	26.22	
123	138	159	227		2.5	2.5	18.8	HJ2322E	1.31	14	26.22	
123	138	159	227		2.5	2.5	18.7	HJ2322E	1.31	14	26.22	
123	138	146	227		2.5	2.5	18.3	HJ2322E	1.31	14	26.22	
123	133	146	227		2.5	2.5	18.3	HJ2322E	1.31	14	26.22	
123	138	146	227		2.5	2.5	17.6	HJ2322E	1.31	14	26.22	
123	138		227	215	2.5	2.5	17.5					
123	138	146	227		2.5	2.5	18.6					
126	150		264	240	3	3	21.8					
126	150	158	264		3	3	22.0					
126	129	174	264		3	3	22.3					
126	130		158	150	1	1	1.74					