

Single-row Cylindrical Roller Bearing

d 60 mm

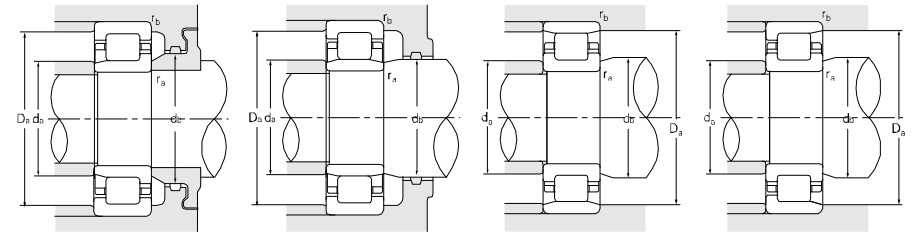
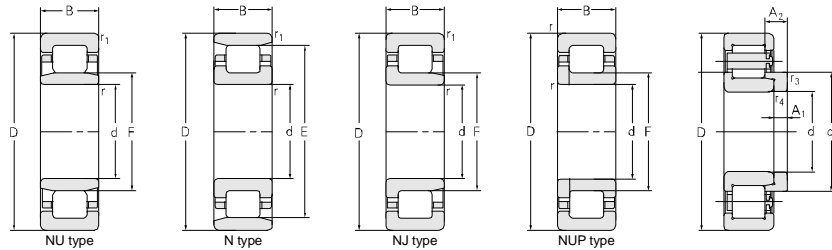

Principal dimensions						Basic load ratings		Limit speed ratings		Designations	
d	D	B	r <sub>1smin</sub>	r <sub>smin</sub>	F	E	C <sub>r</sub>	C <sub>0r</sub>	Grease		Oil
mm						kN		r/min			
60	110	28		1.5	73.5		140	145	5300	6300	NUP2212M
	110	28	1.5	1.5	72		140	145	5300	6300	NU2212EM
	110	28	1.5	1.5	72		140	145	5300	6300	NJ2212EM
	110	28	1.5	1.5	72		140	145	5300	6300	NJ2212ETN1
	110	36.51	1.5	1.5	72.39		150	195	4800	5600	NU5212XPC3
	110	36.51	1.5	1.5	72.39		150	195	4800	5600	NU3212X2M/C9YA6
	110	60	1.5	1.5	73.5		105	130	5300	6300	NU2212WBM/C3
	130	31	2.1	2.1		113	165	150	4300	5000	N312M
	130	31	2.1	2.1	77		141	150	4300	5000	NU312M
	130	31	2.1	2.1	77		141	150	4300	5000	NU312Q1
	130	31	2.1	2.1	77		141	150	4300	5000	NJ312M
	130	31	2.1	2.1		115	165	155	4300	5000	N312E
	130	31	2.1	2.1		115	165	155	4300	5000	N312EM
	130	31	2.1	2.1		115	165	155	4300	5000	N312ETN1
	130	31	2.1	2.1		115	165	155	4300	5000	NF312E
	130	31	2.1	2.1		115	165	155	4300	5000	NF312EM
	130	31	2.1	2.1	77		165	155	4300	5000	NJ312E
	130	31	2.1	2.1	77		165	155	4300	5000	NJ312EM/YAB
	130	31	2.1	2.1	77		165	155	4300	5000	NU312E
	130	31	2.1	2.1	77		165	155	4300	5000	NU312EM
	130	31	2.1	2.1	77		165	155	4300	5000	NU312ETN1
	130	31	2.1	2.1	77		165	155	4300	5000	NU312ETN1/C9
	130	31	2.1	2.1	77		165	155	4300	5000	NUP312E
	130	31	2.1	2.1	77		165	155	4300	5000	NUP312E/C9
	130	31	2.1	2.1	77		165	155	4300	5000	NUP312ENRM
	130	31	2.1	2.1	77		165	155	4300	5000	NUP312ENR/J/C3
	130	31	2.1	2.1	77	113	140	150	4300	5000	N312TN1
	130	31	2.1	2.1	77		140	150	4300	5000	NJ312TN1
	130	46	2.1	2.1	77	113	190	215	4300	5000	N2312M
	130	46	2.1	2.1	77		190	215	4300	5000	NJ2312M/C4W124YA8
	130	46	2.1	2.1	77		190	215	4300	5000	NJ2312M
	130	46	2.1	2.1	78		190	215	4300	5000	NJ2313M
	130	46	2.1	2.1	77	115	250	255	4300	5000	N2312E
	130	46	2.1	2.1	77		250	255	4300	5000	NU2312ETN1/C9
	130	46	2.1	2.1	77		250	255	4300	5000	NU2312E
	130	46	2.1	2.1	77		250	255	4300	5000	NJ2312E

Abutment and fillet dimensions						Weight	Model	Weight	Separate thrust collar		
d <sub>amin</sub>	d <sub>amax</sub>	d <sub>bmin</sub>	D <sub>amax</sub>	D <sub>amin</sub>	r <sub>amax</sub>				r <sub>bmax</sub>	A1	A2
mm						kg	kg	mm			
68		80	102		1.5	1.5	1.27				
68	70	74	102		1.5	1.5	1.21				
68	70	80	102		1.5	1.5	1.23				
68	70	80	102		1.5	1.5	1.07				
66	70	75	103		1	1	1.75				
66	70	75	103		1	1	1.75				
68	70	74	102		1.5	1.5	1.57				
71	110			116	2	2	2.04				
71	72	80	119		2	2	2.06				
71	72	80	119		2	2	2.03				
71	72	86	119		2	2	2.10				
71	112			118	2	2	1.94				
71	112			118	2	2	2.06				
71	112			118	2	2	1.79				
71				118	2	2	2.00				
71				118	2	2	2.12				
71	74	87	119		2	2	1.98				
71	74	87	119		2	2	2.10				
71	74	79	119		2	2	1.94				
71	74	79	119		2	2	2.06				
71	74	79	119		2	2	1.78				
71	74	79	119		2	2	1.78				
71		87	119		2	2	2.03				
71		87	119		2	2	2.03				
71		87	119		2	2	2.2				
71		87	119		2	2	1.92				
71	110			116	2	2	1.78				
71	72	86	119		2	2	1.83				
71	110			117	2	2	2.95				
71	73	80	119		2	2	3.39				
71	73	87	119		2	2	3.38				
71	73	87	119		2	2	3.39				
71	112			118	2	2	2.93				
71	112			118	2	2	2.79				
71	73	80	119		2	2	2.95				
71	73	87	119		2	2	3.00				