

Single-row Angular Contact Ball Bearing

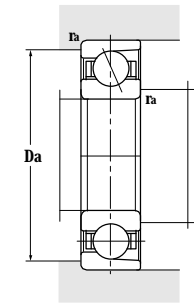

d 25-40 mm

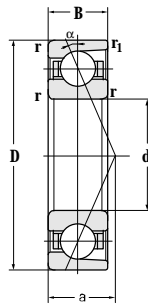

Principal dimensions					Basic load ratings		Limit speed ratings	
d	D	B	r	r ₁	C _r	C _{or}	Grease	Oil
mm					kN		r/min	
25	47	12	0.6	0.3	11.1	8.1	10000	15000
	52	15	1	1	15.9	9.6	10000	15000
	62	17	1.1	0.6	28.6	16.0	10000	15000
	62	17	1.1	0.6	24.7	14.0	9000	13000
30	55	13	1	1	14.3	10.0	1000	13000
	62	16	1.1	0.3	21.0	14.0	8500	12000
	72	19	1.1	0.6	31.8	21.0	8500	13000
	72	19	1.1	0.6	31.0	19.5	8000	11000
	72	19	1.1	0.6	33.6	18.0	8000	11000
35	72	17	1.1	1.1	30.5	20.7	8000	11000
	72	17	1.1	0.6	32.5	22.0	9000	12000
	72	17	1.1	0.6	27.0	19.0	8000	11000
	72	17	1.1	0.6	29.0	18.0	8000	11000
	80	21	1.5	0.6	40.3	26.0	8000	11000
35	80	21	1.5	0.6	39.0	25.0	7800	10500
	80	21	1.5	0.6	39.0	25.0	7500	10000
	80	21	1.5	0.6	39.0	25.0	6000	8000
	100	25	1.5	0.6	70.2	42.0	6300	8000
	100	25	1.5	0.6	70	42.0	6000	8000
40	68	15	1	1	20.5	15.9	8300	11000
	80	18	1.1	0.6	36.4	25.0	8000	11000
	80	18	1.1	0.6	36.4	25.0	6400	8800
	80	18	1.1	0.6	47.2	21.5	10000	15000
	80	18	1.1	0.6	34.5	24.1	7000	9500
	80	18	1.1	0.6	34.5	24.1	7000	9500
	90	23	1.5	0.6	46.8	32.5	7600	10000
	90	23	1.5	0.6	46.8	31.0	6000	8000
	90	23	1.5	0.6	46.8	30.0	6000	8000
	90	23	1.5	0.6	46.8	30.0	6000	8000

Designations	Contact points a	Abutment and fillet dimensions			Weight kg
		damax	Damax	ramax	
		mm			
7005AC	22.8	25	43	0	0.0758
7205C	24	30.6	46	1	0.14
7305C	14.3	32	55	1	0.224
7305BM	27.2	32	55	1	0.277
7006C	12.2	35.5	49.5	1	0.118
7206AC	27	35.6	56	1	0.215
7306C	16.3	37	65	1	0.346
7306ACM	21.6	37	65	1	0.413
7306BM	30.9	37	65	1	0.371
7207AC	31	42	65	1	0.304
7207C	15.7	42	65	1	0.304
7207BTN1	31	42	65	1	0.285
7207BM	30.9	42	65	1	0.328
7307C	18.2	44	71	1.5	0.335
7307ACM	24.1	44	71	1.5	58.5
7307BM	35	44	71	1.5	0.551
7307B	35	44	71	1.5	0.481
7407ACM	28.3	44	91	1.5	1.14
7407AC	41	46	89	1.5	0.977
7008C	14.8	45.5	62.5	1	0.188
7208C	17	47	73	1	0.364
B7208C	17	47	73	1	0.383
7208CTN1/HQ1	17	47	73	1	0.312
7208AC	34	47	73	1	0.367
7208ACM	34	47	73	1	0.429
7308C	20.2	49	81	1.5	0.624
7308ACM	26.7	49	81	1.5	0.711
7308B	38.8	49	81	1.5	0.653
7308BM	38.8	49	81	1.5	0.711