

Single-row Cylindrical Roller Bearing

d 70 mm

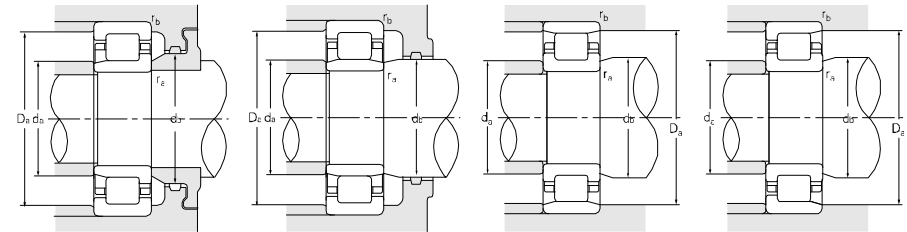
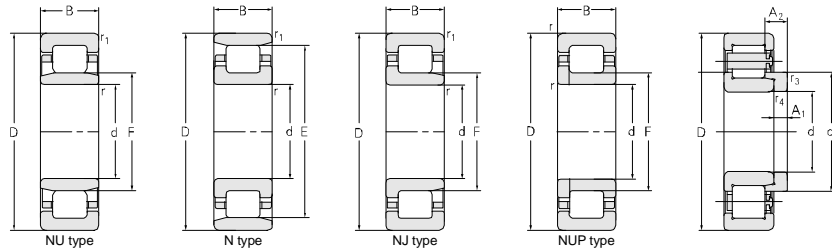

Principal dimensions						Basic load ratings		Limit speed ratings		Designations	
d	D	B	r _{1smin}	r _{smin}	F	E	C _r	C _{0r}	Grease		Oil
mm							kN		r/min		
70	125	24	1.5	1.5	84.5		92.4	116	4500	5300	NU214Q1
	125	24	1.5	1.5	84.5		92.4	116	4500	5300	NU214M
	125	24	1.5	4.3		113.5	132	152	4500	5300	NF214E/J/C9YB2
	125	24	1.5	1.5		113.5	132	152	4500	5300	N214E
	125	24	1.5	1.5		113.5	132	152	4500	5300	NF214E
	125	24	1.5	4.3		113.5	132	152	4500	5300	NF214E/C9YB2
	125	24	1.5	4.3		113.5	132	152	4500	5300	NF214ETN1/C9YB2
	125	24		1.5	83.5		132	152	4500	5300	NUP214E
	125	24	1.5	1.5	83.5		132	152	4500	5300	NJ214E
	125	24	1.5	1.5	83.5		132	152	4500	5300	NU214ETN1/C9
	125	24	1.5	1.5	83.5		132	152	4500	5300	NJ214E/YA6
	125	24	1.5	1.5	83.5		132	152	4500	5300	NU214E
	125	31		1.5	84.5		130	155	4500	5300	NUP2214M
	125	31	1.5	1.5		110.5	130	155	4500	5300	N2214M
	125	31	1.5	1.5	84.5		130	155	4500	5300	NU2214M
	125	31	1.5	1.5	84.5		130	155	4500	5300	NJ2214M
	125	39.69	1.5	1.5	84.76		166	232	4500	5300	NU5214XPC3
	125	39.69	1.5	1.5	84.76		166	232	4500	5300	NU5214/C9YA6
	125	39.69	1.5	1.5	84.76		166	232	4500	5300	NU3214X2M/C9YA6
	125	41	1.5	1.5	84.5		130	155	4500	5300	NU2214WBM/C2
	150	35	2.1	2.1	90		182	202	3600	4300	NJ314Q1
	150	35	2.1	2.1		130	182	202	3600	4300	N314M
	150	35	2.1	2.1		130	182	202	3600	4300	N314J
	150	35	2.5	2.5	90		182	202	3600	4300	NU314M
	150	35	2.5	2.5	90		182	202	3600	4300	NJ314M
	150	35	2.1	2.1		130	182	202	3600	4300	NF314M
	150	35	2.1	2.1	90		182	202	3600	4300	NU314Q1
	150	35	3	2.1	90		182	202	3600	4300	NU314NRM/YAB
	150	35	2.1	2.1	90		185	202	3600	4300	NU314NM/YB2
	150	35	2.1	2.1	90		185	202	3600	4300	NU314NTN1/YB2
	150	35	2.1	2.1		133	226.5	220	3600	4300	N314E
	150	35	2.1	2.1		133	226.5	220	3600	4300	N314EM
	150	35	2.1	2.1	89		226.5	220	3600	4300	NJ314E/C9
	150	35	2.1	2.1	89		226.5	220	3600	4300	NU314E
	150	35	2.1	2.1	89		226.5	220	3600	4300	NJ314E
	150	35	2.1	2.1	89		226.5	220	3600	4300	NJ314EM/YAB

Abutment and fillet dimensions								Weight	Model	Weight	Separate thrust collar		
d _{amin}	d _{amax}	d _{bmin}	D _{amax}	D _{amin}	r _{amax}	r _{bmax}					A1	A2	r _{3,4}
mm							kg	kg	mm				
78	81	86	117		1.5	1.5	1.23						
78	81	86	117		1.5	1.5	1.24						
78			117	116	4	1.5	1.21						
78	111		117	116	1.5	1.5	1.29						
78			117	116	1.5	1.5	1.31						
78			117	116	4	1.5	1.33						
78			117	116	4	1.5	1.17						
78		92	117		1.5	1.5	1.39						
78	81	92	117		1.5	1.5	1.34						
78	81	92	117		1.5	1.5	1.16						
78	81	92	117		1.5	1.5	1.34						
78	81	86	117		1.5	1.5	1.32						
78		92	117		1.5	1.5	1.8						
78	81		117	100	1.5	1.5	1.68						
78	81	86	117		1.5	1.5	1.70						
78	81	92	117		1.5	1.5	1.73						
76.5	82.5	86.5	118.5		1	1	2.17						
76.5	82.5	86.5	118.5		1	1	2.17						
76.5	82.5	86.5	118.5		1	1	2.17						
78	81	86	117		1.5	1.5	1.88						
81	86	100	139		2	2	3.11						
81	127		139	133	2	2	3.00						
81	127		139	133	2	2	2.78						
81	86	93	139		2	2	3.05						
81	86	100	139		2	2	3.12						
81			139		2	2	3.08						
81	86	92	139		2	2	3.03						
81	86	92	139		2	2	3.05						
81	86	93	139		2	2	2.96						
81	86	93	139		2	2	2.66						
81	130		139	136	2	2	3.00						
81	130		139	136	2	2	3.08						
81	86	100	139		2	2	3.06						
81	86	92	139		2	2	3.01						
81	86	100	139		2	2	3.06						
81	86	100	139		2	2	3.14						