

Deep Groove Ball Bearing

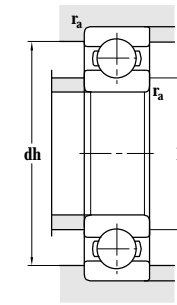

d 70-80 mm

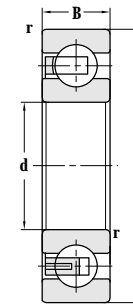
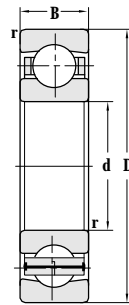
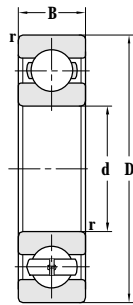

Principal dimensions				Basic load ratings		Limit speed ratings	
d	D	B	r _{min}	C _r	C _{or}	Grease	Oil
mm				kN		r/min	
70	150	35	2.1	107	68.0	4500	5300
	150	35	2.1	107	68.0	4500	5300
	180	42	3	136	100	3800	4500
72	110	20	1.1	38.0	31.0	5200	6500
	115	20	1.1	38.0	31.0	5600	6700
	115	20	1.1	38.0	31.0	5600	6700
75	105	16	1	26.5	23.5	5600	6700
	115	13	0.6	29.0	26.0	5600	6700
	115	13	0.6	29.0	26.0	5600	6700
	115	13	1.1	24.8	23.9	5600	6700
	130	25	1.5	66.0	50.0	4800	5600
	130	25	1.5	66.0	50.0	4800	5600
	130	25	1.5	66.0	50.0	4800	5600
	130	25	1.5	66.0	50.0	4800	5600
	130	31	1.5	66.0	50.0	4800	5600
	160	37	2.1	113	77	4300	5000
	160	37	2.1	113	77	4300	5000
	160	37	2.1	113	77	4300	5000
	160	37	2.1	113	77	4300	5000
	160	37	2.1	113	77	4300	5000
	160	37	2.1	113	77	4300	5000
190	45	3	146	107	3600	4300	
80	100	10	0.6	12.7	13.3	6000	7000
	110	16	1	27.5	25.0	5600	6700
	125	22	1.1	47.5	40.0	5300	6300
	125	22	1.1	47.5	40.0	6500	8000
	125	14	0.6	32.0	30.0	5300	6300
	125	22	1.1	47.5	40.0	5300	6300
	140	26	2	71.5	54.5	4500	5300
	140	26	2	71.5	54.5	4500	5300
	170	39	2.1	125	86.5	3800	4500
	170	39	2.1	125	86.5	3800	4500

Designations	Abutment and fillet dimensions			Weight
	D _{smin}	dh _{max}	ra _{max}	
	mm			kg
6314/YA6	81	139	2	2.58
6314TN1	81	139	2	2.50
6414	83	167	2.5	4.54
60/72	79.5	102.5	1	0.584
6015	81.5	108.5	1	0.630
6015M	81.5	108.5	1	0.804
61915	80	100	1	0.350
16015	81.5	108.5	0.6	0.546
16015M	81.5	108.5	0.6	0.546
16015/YA6	84.5	105.5	1	0.476
6215	83	122	1.5	1.21
6215A	83	122	1.5	1.21
6215M	83	122	1.5	1.46
6215K	83	122	1.5	1.18
62215	83	122	1.5	1.47
6315	86	149	2	3.03
6315A	86	149	2	3.03
6315/CM	86	149	2	3.02
315U1	86	149	2	3.02
6315/YA8	86	149	2	3.03
6315M	86	149	2	3.86
6415	88	177	2.5	5.88
61816	83.2	96.8	0.6	0.153
61916	85	105	1	0.350
6016	86.5	118.5	1	0.845
FL-6016/P6	86.5	118.5	1	0.845
16016	84	121	0.6	0.599
6016M	86.5	118.5	1	1.04
6216A	89	131	2	1.47
6216	89	131	2	1.47
6316	91	159	2	3.68
6316/CM	91	159	2	3.60