

closed housing, can be relubricated, equipped with LBCD .. D bearing, self-aligning
 F_w 12 – 40 mm

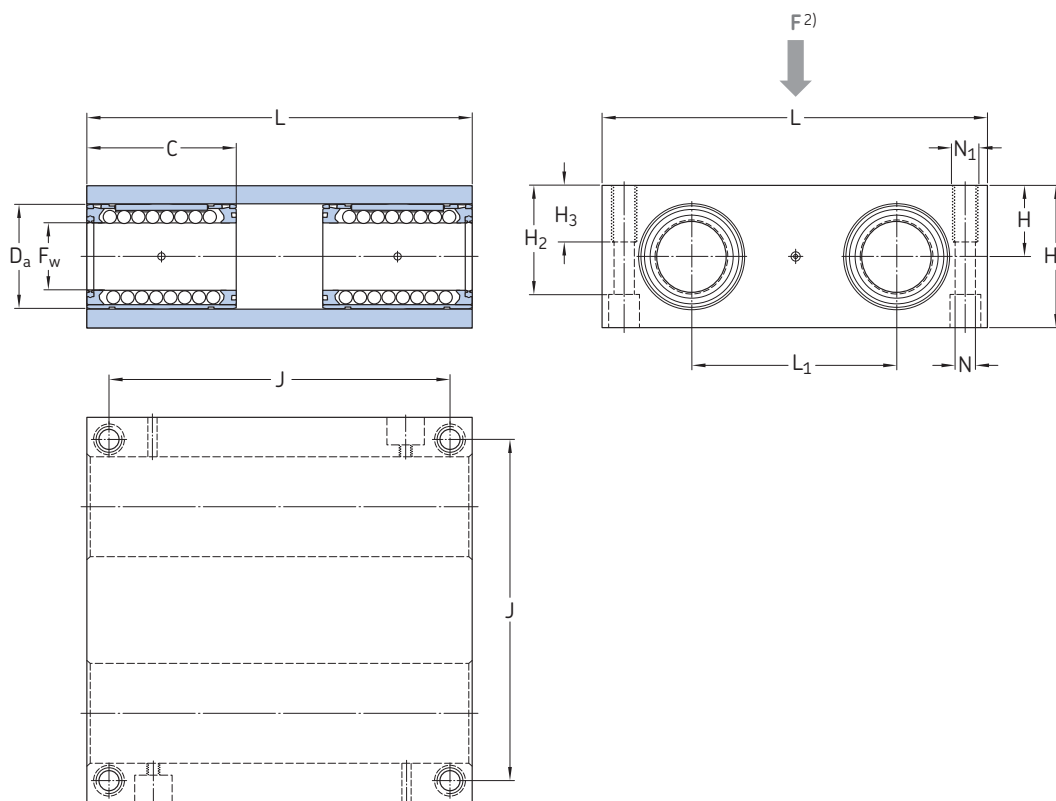

With double lip seals on the outside

Dimensions											Basic load ratings				Mass	Designations Linear bearing unit with double lip seals	
F _w	C	D _a	H ±0,01	H ₁	H ₂	H ₃	J	L	L ₁	N ¹⁾	N ₁ ¹⁾	dynamic		static			
											C _{min}	max	C ₀ min	max			
mm											N				kg	–	
12	32	22	16	32	25	13	73	85	42	5,3	M 6	2 120	3 200	2 280	3 750	0,512	LQCD 12 D-2LS
16	36	26	18	36	29	13	88	100	54	5,3	M 6	2 500	3 650	2 600	4 250	0,764	LQCD 16 D-2LS
20	45	32	23	46	37,5	18	115	130	72	6,6	M 8	4 550	6 700	4 500	7 200	1,732	LQCD 20 D-2LS
25	58	40	28	56	45	22	140	160	88	8,4	M 10	6 800	10 000	5 700	9 300	3,114	LQCD 25 D-2LS
30	68	47	32	64	50,5	26	158	180	96	10,5	M 12	10 000	14 600	9 300	15 000	4,23	LQCD 30 D-2LS
40	80	62	40	80	64	34	202	230	122	13,5	M 16	17 300	25 500	13 400	22 800	8,14	LQCD 40 D-2LS

Upon request LQCD .. D linear ball bearing units are available with ball bearings in stainless steel execution. Designation: e.g. LQCD 20 D-2LS/HV6

For suitable shaft blocks for these bearing units, designation LEAS .. A and LEAS .. B → *Linear bearings and units* (4182 EN).

¹⁾ For 4 cylindrical screws with internal hexagon to DIN 912 / ISO 4762.
²⁾ Direction for max. load ratings