

## Extensions for inserts

Steel extensions for inserts with thread M2.5.

Item No.	Length mm
<b>Extensions with <math>A = \varnothing 4</math> mm:</b>	
852.446	10
852.447	15
852.448	20
852.449	25
852.450	30
852.451	35
852.452	40
852.453	45
852.454	50
852.455	55
852.456	60
852.457	65
852.458	70
852.459	75
852.460	80
852.461	85
852.462	90
852.463	95
852.464	100

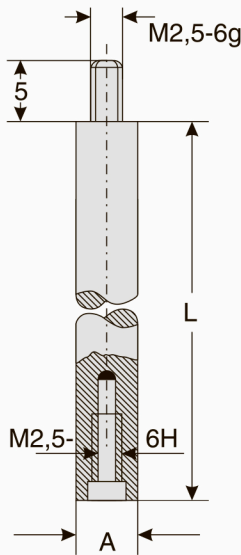

Item No.	Length mm
<b>Extensions with <math>A = \varnothing 5</math> mm:</b>	
852.465	10
852.466	15
852.467	20
852.468	25
852.469	30
852.470	35
852.471	40
852.472	45
852.473	50
852.474	55
852.475	60
852.476	65
852.477	70
852.478	75
852.479	80
852.480	85
852.481	90
852.482	95
852.483	100

## Adapters for inserts

Adapter for attaching other inserts to dial indicators and probes with an interchangeable insert with thread M2.5.

Item No.	External/internal thread
783.034	M2.5/M2

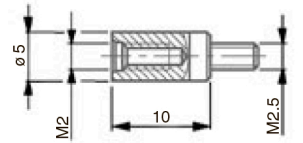

## Depth measuring bases for dial indicators

Bases which make dial indicators and probes suitable for depth measurements.

■ Clamping shaft: 8H7.

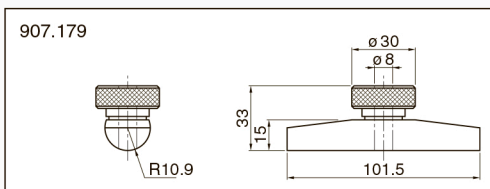
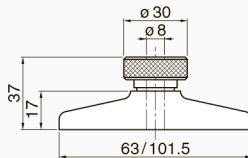

Item No.	Measuring face l x w/mm
907.153	63 x 17
907.165	101.5 x 17
<b>With cylindrical measuring face:</b>	
907.179	101.5 x R10.9