

UCTX Mittlere Reihe - Средняя серия

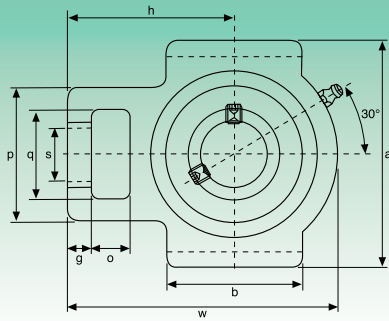
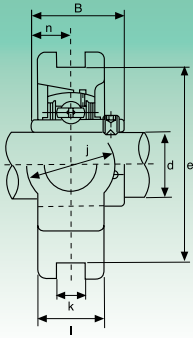

Typ Tun	Abmessungen - Размеры															Tragzahlen (N) Коэффициент нагрузки (H)		Lager Подшипник	Gehäuse Корпус	Gewicht Вес kg		
	d	o	g	p	q	s	b	k	e	a	w	j	l	h	B	n	dynamisch C Динамическая C				statisch C _s Статическая C _s	
	mm/Zoll - мм/дюйм																					
UCTX05	25	16	12	56	37	22	57	12	89	102	113	28	37	70	38,1	15,9	18525	10735	UCX05	TX05	1,4	
UCTX05-13	13/16																					UCX05-13
UCTX05-14	7/8	5/8	15/32	27/32	129/64	55/64	2 1/4	0,472	3 1/2	41/64	429/64	13/32	129/64	2 3/4	1,5000	0,626						UCX05-14
UCTX05-15	15/16																					UCX05-15
UCTX05-16	1																					UCX05-16
UCTX06	30	16	15	64	37	22	64	12	89	102	129	30	37	78	42,9	17,5	24415	14630	UCX06	TX06	1,8	
UCTX06-17	11/16																					UCX06-17
UCTX06-18	11/8	5/8	19/32	233/64	129/64	55/64	233/64	0,472	3 1/2	41/64	55/64	13/16	129/64	35/64	1,6890	0,689						UCX06-18
UCTX06-19	13/16																					UCX06-19
UCTX06-20	1 1/4																					UCX06-20
UCTX07	35	19	17	83	49	29	83	16	102	114	144	36	49	88	49,2	19	27645	16910	UCX07	TX07	2,6	
UCTX07-21	15/16																					UCX07-21
UCTX07-22	13/8	3/4	21/32	317/64	115/16	19/64	317/64	0,630	41/64	431/64	543/64	113/32	115/16	315/32	1,9370	0,748						UCX07-22
UCTX07-23	17/16																					UCX07-23
UCTX08	40	19	17	83	49	29	83	16	102	117	144	36	49	87	49,2	19	32395	20235	UCX08	TX08	2,6	
UCTX08-24	1 1/2	3/4	21/32	317/64	115/16	19/64	317/64	0,630	41/64	439/64	543/64	113/32	115/16	327/64	1,9370	0,748						UCX08-24
UCTX08-25	19/16																					UCX08-25
UCTX09	45	19	18	83	49	29	86	16	102	117	151	38	49	92	51,6	19	33345	22135	UCX09	TX09	2,8	
UCTX09-26	15/8																					UCX09-26
UCTX09-27	111/16	3/4	23/32	317/64	115/16	19/64	325/64	0,630	41/64	439/64	515/16	1 1/2	115/16	35/8	2,0315	0,748						UCX09-27
UCTX09-28	1 3/4																					UCX09-28
UCTX09-29	113/16																					UCX09-29
UCTX10	50	25	21	102	64	35	95	22	130	146	171	42	64	106	55,6	22,2	41230	27930	UCX10	TX10	4,3	
UCTX10-30	17/8																					UCX10-30
UCTX10-31	115/16	63/64	13/16	41/64	21/32	13/8	3 3/4	0,866	51/8	5 3/4	647/64	121/32	233/64	4411/64	2,1890	0,874						UCX10-31
UCTX10-32	2																					UCX10-32
UCTX11	55	32	21	102	64	35	102	22	130	146	194	44	64	119	65,1	25,4	49780	34390	UCX11	TX11	5,2	
UCTX11-33	21/16																					UCX11-33
UCTX11-34	21/8																					UCX11-34
UCTX11-35	23/16	117/64	13/16	41/64	21/32	13/8	41/64	0,866	51/8	5 3/4	741/64	123/32	233/64	4411/16	2,5630	1,000						UCX11-35
UCTX11-36	2 1/4																					UCX11-36
UCTX11-37	25/16																					UCX11-37
UCTX12	60	32	23	111	70	41	121	26	151	167	224	48	70	137	65,1	25,4	54340	38095	UCX12	TX12	7,6	
UCTX12-38	23/8																					UCX12-38
UCTX12-39	27/16	117/64	29/32	43/8	2 3/4	139/64	449/64	1,024	515/16	637/64	813/16	157/64	2 3/4	525/64	2,5630	1,000						UCX12-39
UCTX13	65	32	23	111	70	41	121	26	151	167	224	48	70	137	74,6	30,2	59090	41895	UCX13	TX13	7,6	
UCTX13-40	2 1/2																					UCX13-40
UCTX13-41	29/16	117/64	29/32	43/8	2 3/4	139/64	449/64	1,024	515/16	637/64	813/16	157/64	2 3/4	525/64	2,9370	1,189						UCX13-41
UCTX14	70	32	23	111	70	41	121	26	151	167	232	48	70	140	77,8	33,3	64030	45885	UCX14	TX14	7,7	
UCTX14-42	25/8																					UCX14-42
UCTX14-43	211/16	117/64	29/32	43/8	2 3/4	139/64	449/64	1,024	515/16	637/64	99/64	157/64	2 3/4	533/64	3,0630	1,311						UCX14-43
UCTX14-44	2 3/4																					UCX14-44
UCTX15	75	32	23	111	70	41	121	28	165	184	235	48	70	140	82,6	33,3	69065	50350	UCX15	TX15	7,55	
UCTX15-45	213/16																					UCX15-45
UCTX15-46	27/8																					UCX15-46
UCTX15-47	215/16	117/64	29/32	43/8	2 3/4	139/64	449/64	1,102	6 1/2	7 1/4	9 1/4	157/64	2 3/4	533/64	3,2520	1,311						UCX15-47
UCTX15-48	3																					UCX15-48
UCTX16	80	38	30	124	73	48	157	28	173	198	260	54	73	162	85,7	34,1	79800	58805	UCX16	TX16	11	
UCTX16-49	31/16																					UCX16-49
UCTX16-50	31/8	1 1/2	13/16	47/8	27/8	157/64	63/16	1,102	613/16	751/64	1015/64	21/8	27/8	63/8	3,3740	1,343						UCX16-50
UCTX16-51	33/16																					UCX16-51
UCTX16-52	3 3/4																					UCX16-52
UCTX17	85	38	30	124	73	48	157	28	173	198	260	54	73	162	96	39,7	91295	67925	UCX17	TX17	12	
UCTX17-53	35/16	1 1/2	13/16	47/8	27/8	157/64	63/16	1,102	613/16	751/64	1015/64	21/8	27/8	63/8	3,7795	1,5630						UCX17-53
UCTX17-54	37/16																					UCX17-55