

# Workshop calipers

Large and solid, stainless steel calipers with no-glare chrome finished scale and vernier.

- Measuring range: 0 - 2000 mm.
- Vernier: 0.02 mm / 1/1000 inch or 0.05 mm / 1/128 inch.
- Fine adjustment.
- With or without measuring knives for internal or external measurements.
- Rounded jaw ends for internal measurements; measuring range  $\leq 600$  mm:  $K = 10$  mm, measuring range  $> 600$  mm:  $K = 20$  mm.
- DIN 862.
- Delivery in a case with a declaration of conformity.

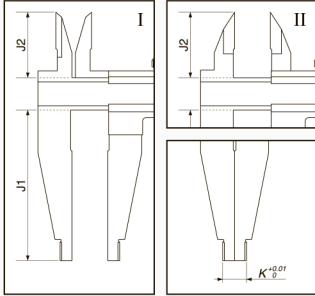

## Vernier 0.05 mm / 1/128 inch

Item No.	Measuring range mm	Length mm		
		J1	J2	K
<b>Without measuring knives:</b>				
909.670	0 - 300	90	-	10
909.620	0 - 450	150	-	10
909.621	0 - 500	150	-	10
909.622	0 - 600	150	-	10
909.623	0 - 800	150	-	20
909.624	0 - 1000	150	-	20
909.639	0 - 1500	200	-	20
909.640	0 - 2000	200	-	20

### Meas. knives for internal measurements (I):

909.672	0 - 300	90	22	10
909.632	0 - 400	100	46	10
909.633	0 - 500	150	46	10
909.634	0 - 600	150	46	10
909.635	0 - 750	150	54	20
909.636	0 - 1000	150	54	20
909.637	0 - 1500	200	66	20
909.638	0 - 2000	200	66	20

### Meas. knives for external measurements (II):

909.674	0 - 300	90	22	10
909.656	0 - 400	100	46	10
909.657	0 - 500	150	46	10
909.658	0 - 600	150	46	10
909.659	0 - 750	150	54	20
909.660	0 - 1000	150	54	20
909.661	0 - 1500	200	66	20
909.662	0 - 2000	200	66	20

## Vernier 0.02 mm / 1/1000 inch

Item No.	Measuring range mm	Length mm		
		J1	J2	K
<b>Without measuring knives:</b>				
909.671	0 - 300	90	-	10
909.615	0 - 450	150	-	10
909.616	0 - 500	150	-	10
909.617	0 - 600	150	-	10
909.618	0 - 800	150	-	20
909.619	0 - 1000	150	-	20
909.641	0 - 1500	200	-	20
909.642	0 - 2000	200	-	20

### Meas. knives for internal measurements (I):

909.673	0 - 300	90	22	10
909.625	0 - 400	100	46	10
909.626	0 - 500	150	46	10
909.627	0 - 600	150	46	10
909.628	0 - 750	150	55	20
909.629	0 - 1000	150	55	20
909.630	0 - 1500	200	66	20
909.631	0 - 2000	200	66	20

### Meas. knives for external measurements (II):

909.675	0 - 300	90	22	10
909.663	0 - 400	100	46	10
909.664	0 - 500	150	46	10
909.665	0 - 600	150	46	10
909.666	0 - 750	150	55	20
909.667	0 - 1000	150	55	20
909.668	0 - 1500	200	66	20
909.669	0 - 2000	200	66	20