

# PHE 70GCCOVER

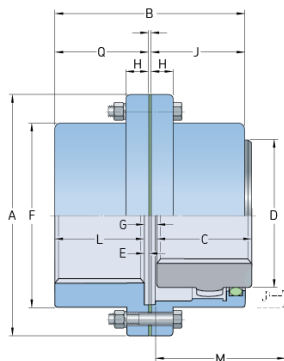

Size	70 GC
Power per 100 r/min (kW)	1420
Rated torque (Nm)	135000
Speed Max. (r/min)	2150
Bore diameter Min. (mm)	127
Bore diameter Max. (mm)	289
A (mm)	527
B (mm)	452
C (mm)	221
D (mm)	343
F (mm)	425
H (mm)	28.4
J (mm)	196
M (mm)	267
Gap G Min. (mm)	10
Lubricant mass (kg)	4.35
Coupling mass without bore and min. DBSE (kg)	485

© SKF is a registered trademark of the SKF Group

© SKF Group 2012

The contents of this publication are the copyright of the publisher and may not be reproduced (even extracts) unless prior written permission is granted. Every care has been taken to ensure the accuracy of the information contained in this publication but no liability can be accepted for any loss or damage whether direct, indirect or consequential arising out of the use of the information contained herein.