



DIN 863 T4  
(Style C2)  
NFE 11-099

000 0,01 mm

Tungsten carbide  
tipped measuring  
bolts and cone

Shipping box

Inspection report  
with a declaration  
of conformity

No  
NO Identification  
number

0,002 mm

Supplied with 1 heat  
insulating sleeve  
(No. 00940020),  
2 keys (No. 00940001),  
1 screwdriver  
(No. 00862801).

### TESA TRI-O-BOR

Self-centring and self-aligning internal micrometers with 3-line contact with the part being inspected.

These micrometers measure trough holes, blind bores and short centring shoulders.

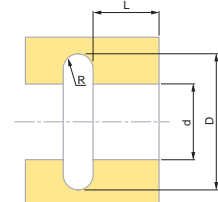
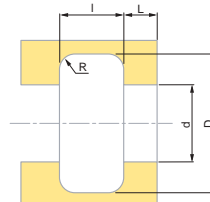
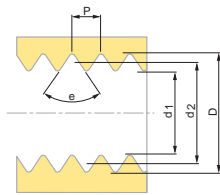
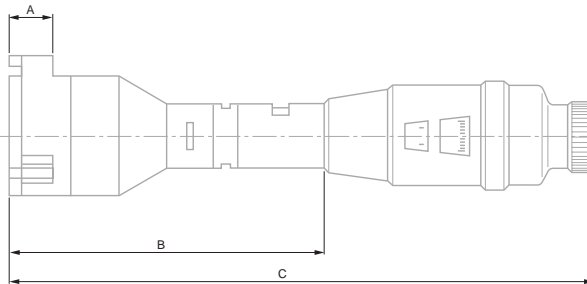

| No       |           |    |    |      |      |       |
|----------|-----------|----|----|------|------|-------|
|          | mm        | µm | µm | A mm | B mm | C mm  |
| 00910005 | 5 ÷ 20    | 4  | 4  | 6    | ≥ 66 | ≤ 132 |
| 00910006 | 20 ÷ 25   | 4  | 4  | 6    | ≥ 66 | ≤ 132 |
| 00910007 | 25 ÷ 30   | 4  | 4  | 6    | ≥ 66 | ≤ 132 |
| 00910405 | 30 ÷ 40   | 4  | 4  | 10   | ≥ 70 | ≤ 138 |
| 00910406 | 40 ÷ 50   | 4  | 4  | 10   | ≥ 70 | ≤ 138 |
| 00910407 | 50 ÷ 60   | 5  | 5  | 10   | ≥ 70 | ≤ 138 |
| 00910705 | 60 ÷ 70   | 5  | 5  | 18   | ≥ 78 | ≤ 147 |
| 00910706 | 70 ÷ 80   | 5  | 5  | 18   | ≥ 78 | ≤ 147 |
| 00910707 | 80 ÷ 90   | 5  | 5  | 18   | ≥ 78 | ≤ 147 |
| 00911105 | 90 ÷ 100  | 5  | 5  | 18   | ≥ 78 | ≤ 147 |
| 00911106 | 100 ÷ 110 | 6  | 6  | 18   | ≥ 78 | ≤ 147 |
| 00911107 | 110 ÷ 120 | 6  | 6  | 18   | ≥ 78 | ≤ 147 |

**OPTIONAL ACCESSORY**

**00940000** Extension of 150 mm for TESA TRI-O-BOR

